

ENTRY MONUMENT WALL.  
TYP.

LOW ACCENT PLANTING  
AT SIGN WALL

**EAST CYPRESS ROAD**

- MEDIUM SIZE SHRUBS AT MEDIAN, TYP.
- GROUNDCOVER AT MEDIAN, TYP.
- MEDIAN TREE, TYP. SEE L3.0 TREE PLAN
- VINES ON SOUND WALL, TYP.
- SOUND WALL, TYP.
- LARGE SIZE SHRUBS AGAINST SOUND WALL, TYP.
- MEDIUM SIZE SHRUBS, TYP.
- SMALL SIZE ACCENT SHRUBS, TYP.
- FOREGROUND GROUNDCOVERS, TYP.
- GROUNDCOVER IN PARK STRIP, TYP.
- SMALL SIZE ACCENT SHRUBS IN PARK STRIP, TYP.
- MEDIUM SIZE SHRUBS IN PARK STRIP, TYP.
- STREET TREE, TYP. SEE L3.0 TREE PLAN
- 8' CONCRETE PUBLIC TRAIL, TYP.
- CONCRETE MEDIAN

- NOTE:
1. PLANTING DESIGN TO CONTINUE ALONG STREET FRONTAGE
  2. STREET TREES ARE CONSISTENT WITH NEIGHBORING GILLBERT / DELANEY PROPERTY

**A ENTRY ENLARGEMENT**

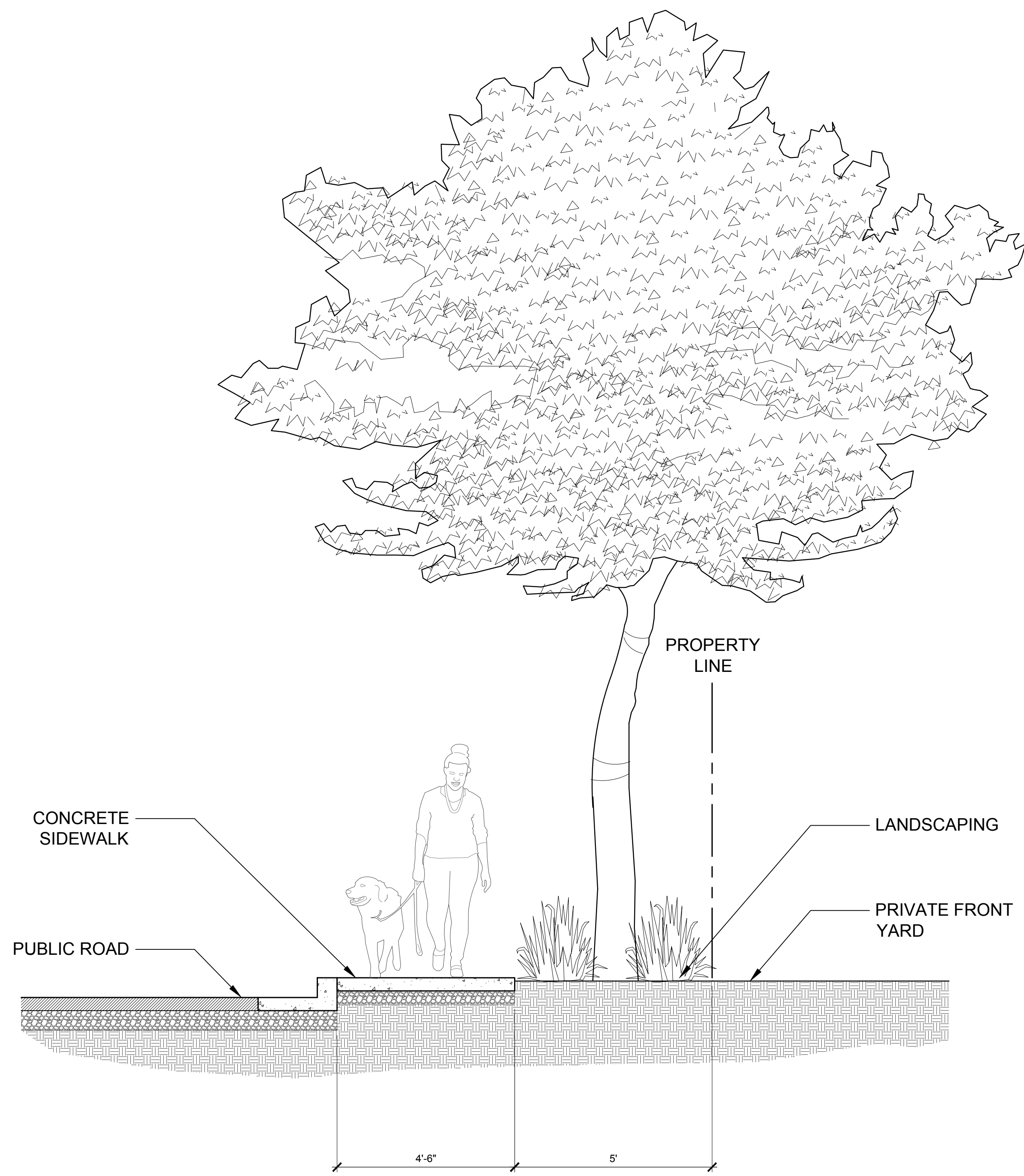

**A** TYPICAL SIDEWALK SECTION

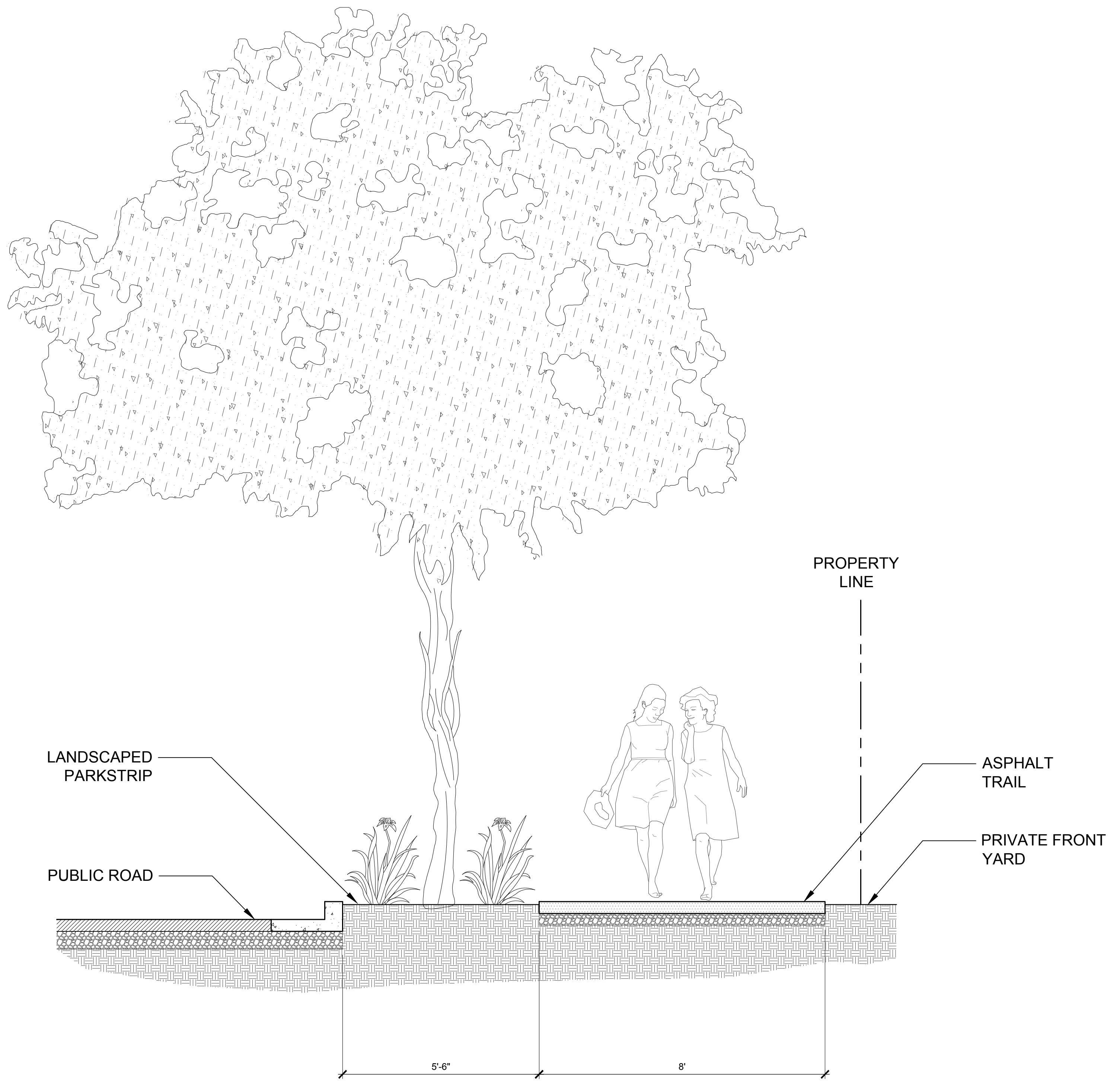

**B** TYPICAL TRAIL SECTION



**DECORATIVE METAL FENCE**



**GOOD NEIGHBOR FENCE**



**VIEW FENCE**



**SOUND WALL**



**ASPHALT TRAIL**



**BENCH**



**REMOVABLE BOLLARD**

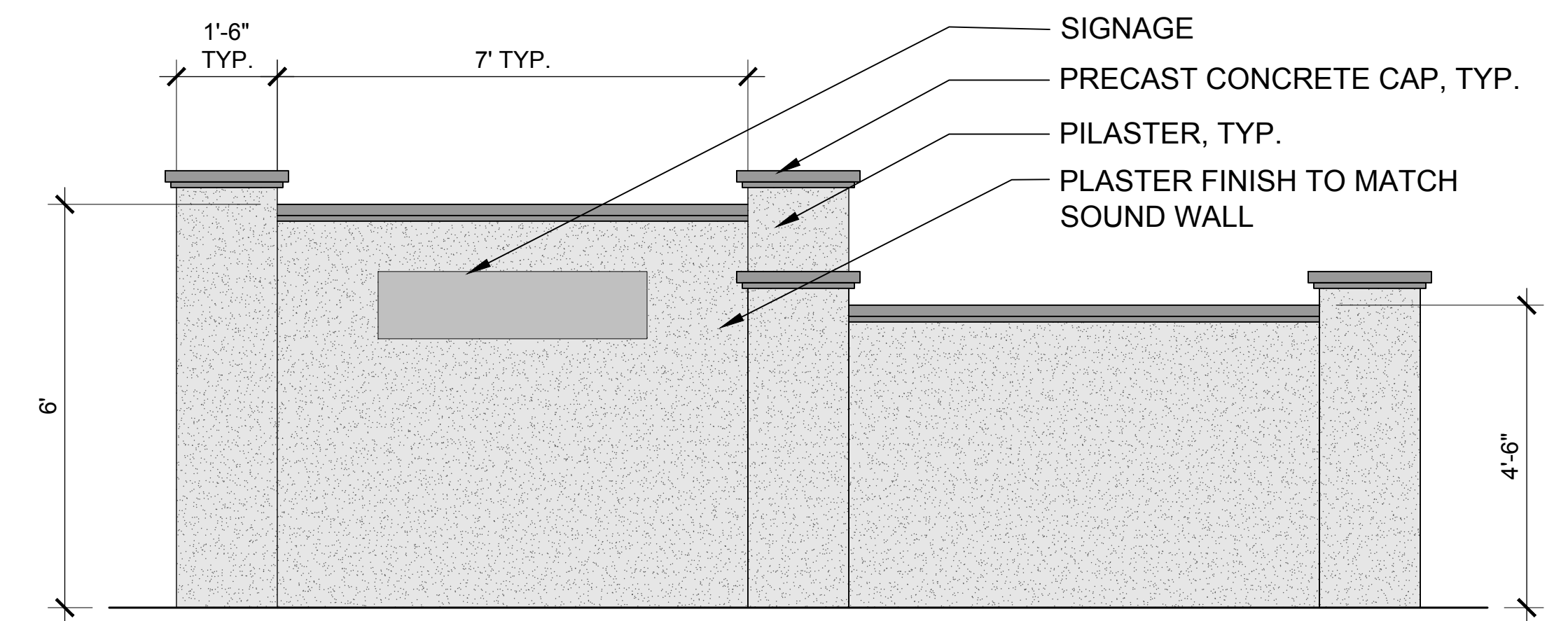

**ENTRY MONUMENT WALL**

SCALE: 1/2" = 1'-0"



*Acer macrophyllum*  
Bigleaf Maple



*Alnus rhombifolia*  
White Alder



*x Chitalpa tashkentensis*  
Chitalpa



*Crataegus phaenopyrum*  
Washington Hawthorn



*Ginkgo biloba*  
Maidenhair Tree

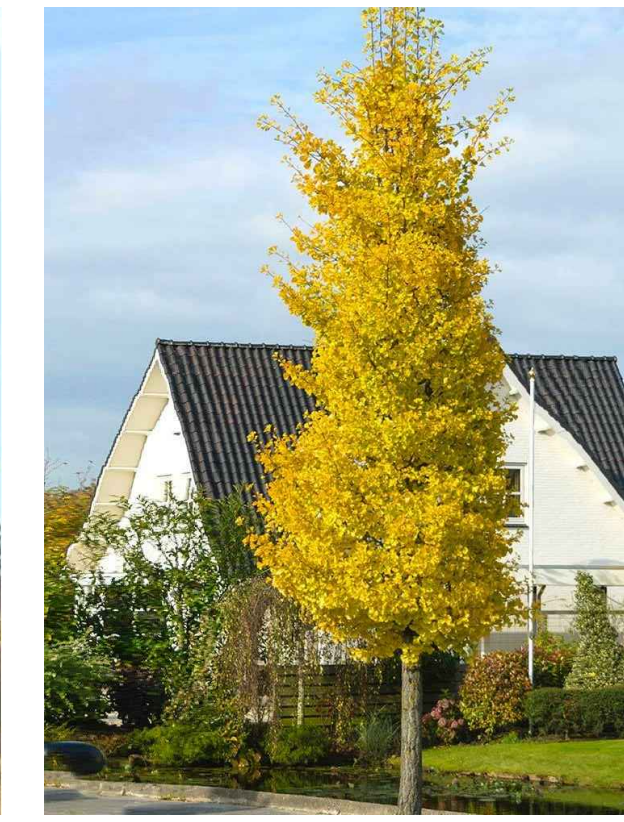

*Ginkgo biloba* 'Princeton Sentry'  
Princeton Sentry Maidenhair Tree



*Populus fremontii* 'Nevada'  
Fremont Cottonwood



*Pyrus calleryana* 'New Bradford'  
New Bradford Flowering Pear



*Quercus agrifolia*  
Coast Live Oak



*Robinia* 'Purple Robe'  
Locust



*Tristanopsis laurina* 'Elegant'  
Elegant Water Gum



*Ulmus parvifolia*  
Chinese Elm

## TREES



## SHRUBS

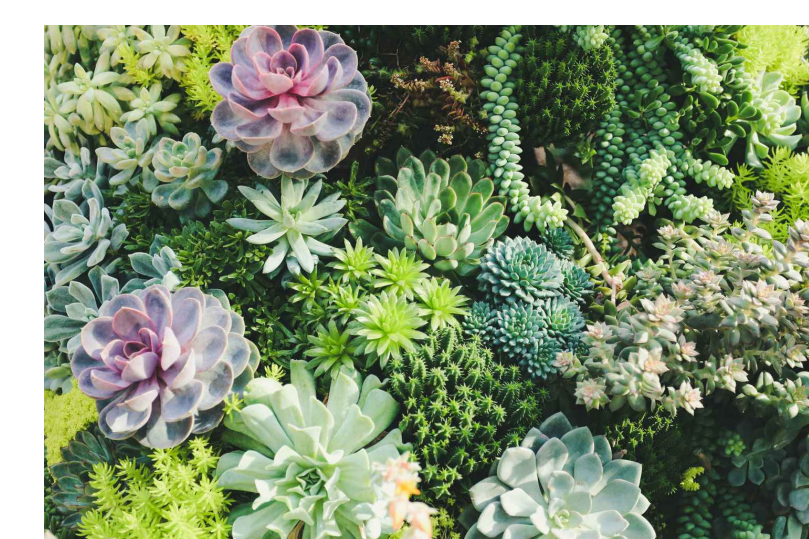

## VINES

## GROUNDCOVER

### TREE LEGEND

#### STREET TREES

| SYMBOL | BOTANICAL NAME                   | COMMON NAME                 |
|--------|----------------------------------|-----------------------------|
|        | X CHITALPA TASHKENTENSIS         | CHITALPA                    |
|        | CRATAEGUS PHAENOPYRUM            | WASHINGTON HAWTHORN         |
|        | GINKGO BILOBA                    | MAIDENHAIR TREE             |
|        | GINKGO BILOBA 'PRINCETON SENTRY' | MAIDENHAIR TREE             |
|        | PYRUS CALLERYANA 'NEW BRADFORD'  | NEW BRADFORD FLOWERING PEAR |
|        | QUERCUS ILEX                     | HOLLY OAK                   |
|        | ROBINIA 'PURPLE ROBE'            | LOCUST                      |
|        | TRISTANIOPSIS LAURINA 'ELEGANT'  | ELEGANT WATER GUM           |
|        | ULMUS PARVIFOLIA                 | CHINESE ELM                 |

#### TREES ALONG LITTLE DUTCH SLOUGH

| SYMBOL | BOTANICAL NAME              | COMMON NAME        |
|--------|-----------------------------|--------------------|
|        | ACER MACROPHYLLUM           | BIGLEAF MAPLE      |
|        | POPULUS FREEMONTII 'NEVADA' | FREMONT COTTONWOOD |
|        | ALNUS RHOMBIFOLIA           | WHITE ALDER        |
|        | QUERCUS AGRIFOLIA           | COAST LIVE OAK     |

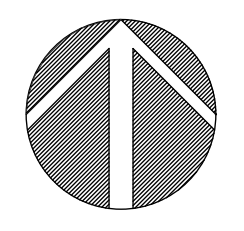
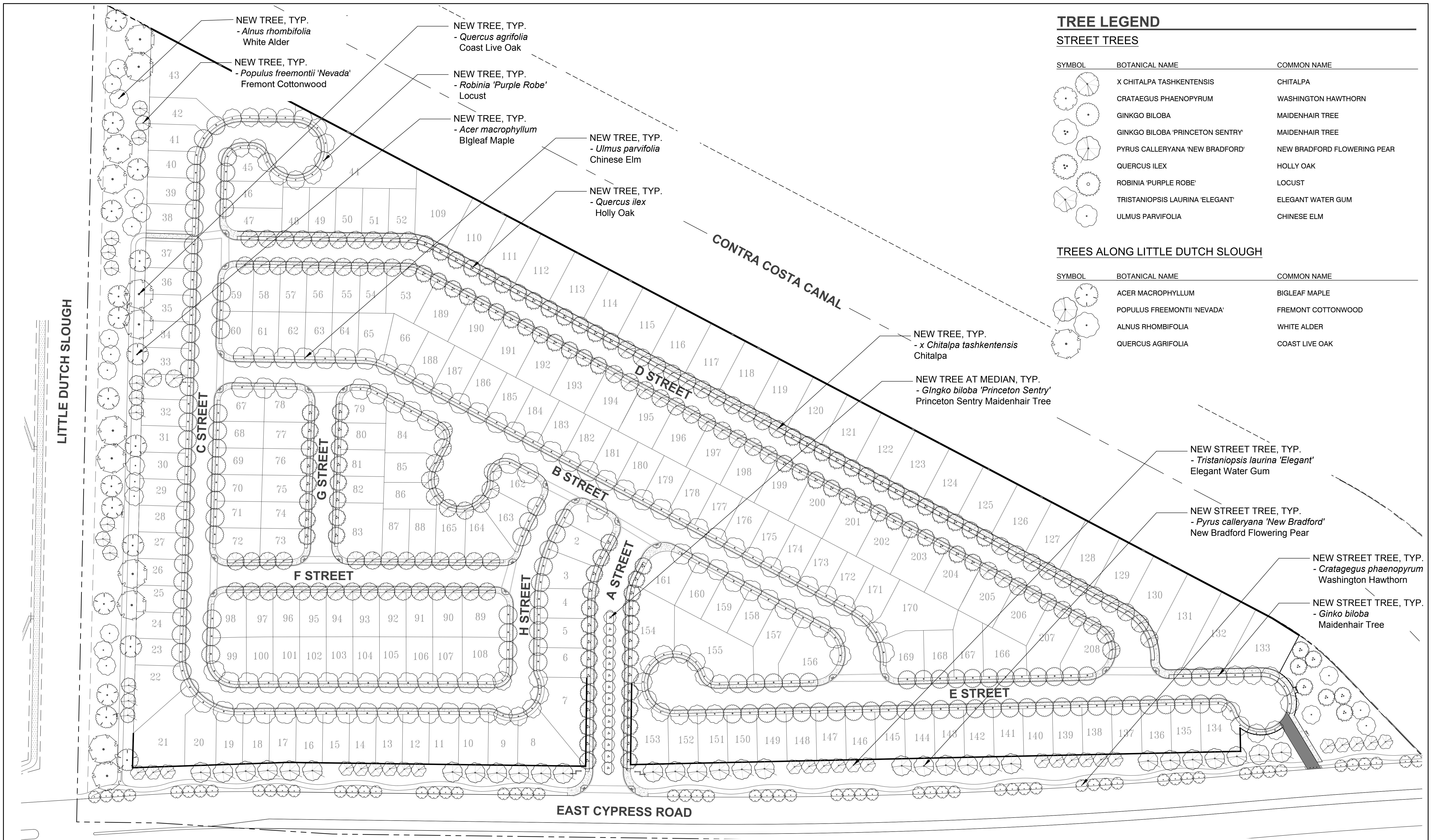

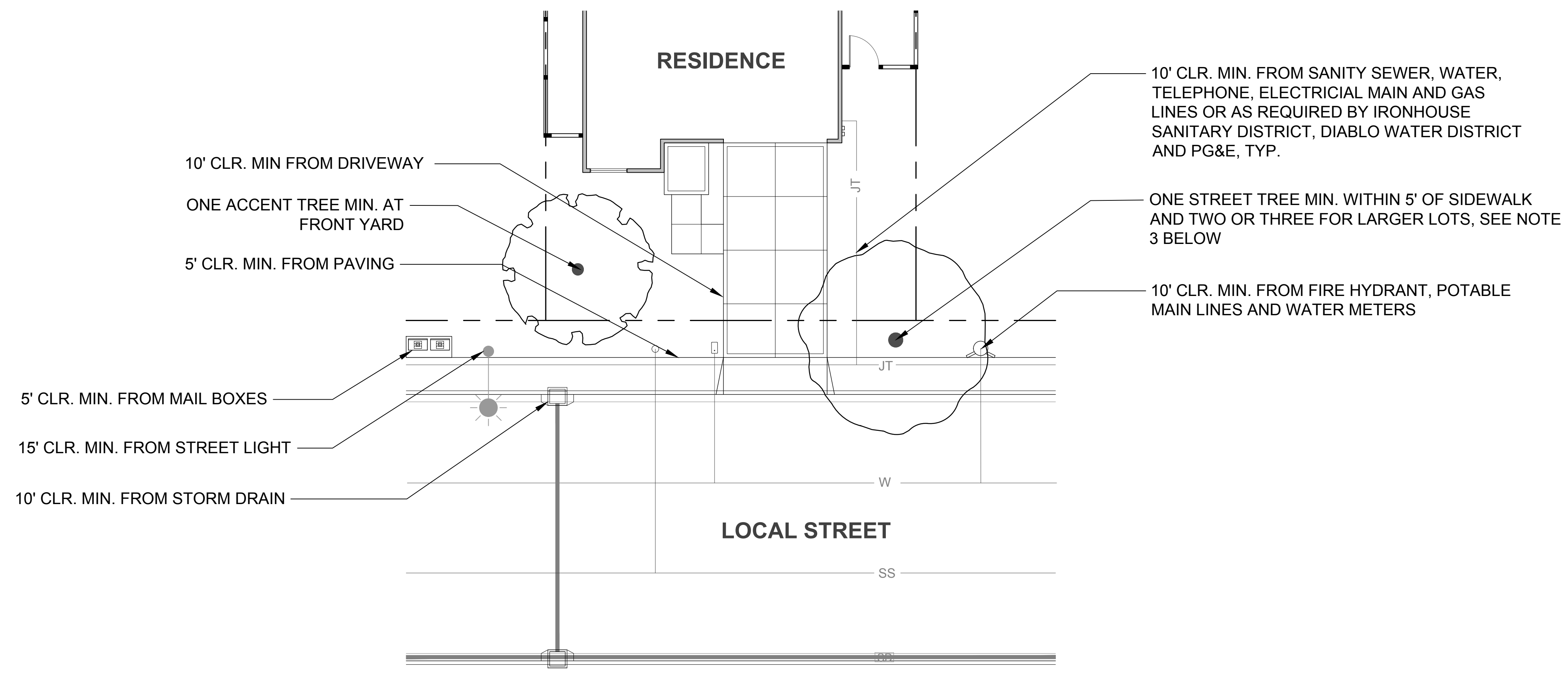

**NOTES:**

1. CLEARANCE SHOWN ARE FOR TREES
2. KEEP TREES 15' CLEAR FROM STOP SIGNS OR CURB RADIUS AND REFER TO PG&E FOR PLANTING REQUIREMENT NEAR OVERHEAD LINES
3. LOT FRONTAGE SIZE, DRIVEWAY LOCATIONS, AND UTILITY LOCATIONS SHALL BE DESIGNED TO ALLOW FOR MAXIMUM STREET TREE PLANTING



# TREE PALETTE

## STREET TREES

| SYMBOL | BOTANICAL NAME                   | COMMON NAME                 | CONT    | WATER USE | MATURE HEIGHT & SPREAD |
|--------|----------------------------------|-----------------------------|---------|-----------|------------------------|
|        | X CHITALPA TASHKENTENSIS         | CHITALPA                    | 24" BOX | L         | 35'H X 30'W            |
|        | CRATAEGUS PHAENOPYRUM            | WASHINGTON HAWTHORN         | 24" BOX | M         | 30'H X 20'W            |
|        | GINKGO BILOBA                    | MAIDENHAIR TREE             | 24" BOX | M         | 35'-50'H X 25'-40'W    |
|        | GINKGO BILOBA 'PRINCETON SENTRY' | MAIDENHAIR TREE             | 24" BOX | M         | 45'H X 20'W            |
|        | PYRUS CALLERYANA 'NEW BRADFORD'  | NEW BRADFORD FLOWERING PEAR | 24" BOX | M         | 30'H X 35'W            |
|        | QUERCUS ILEX                     | HOLLY OAK                   | 24" BOX | L         | 30-60'H X 30-60'W      |
|        | ROBINIA 'PURPLE ROBE'            | LOCUST                      | 24" BOX | L         | 40'H X 30'W            |
|        | TRISTANIOPSIS LAURINA 'ELEGANT'  | ELEGANT WATER GUM           | 24" BOX | M         | 30'H X 30'W            |
|        | ULMUS PARVIFOLIA                 | CHINESE ELM                 | 24" BOX | M         | 45'H X 35'W            |

## TREES ALONG LITTLE DUTCH SLOUGH

| SYMBOL | BOTANICAL NAME              | COMMON NAME        | CONT    | WATER USE | MATURE HEIGHT & SPREAD |
|--------|-----------------------------|--------------------|---------|-----------|------------------------|
|        | ACER MACROPHYLLUM           | BIGLEAF MAPLE      | 24" BOX | H         | 40-75'H X 40-75'W      |
|        | POPULUS FREEMONTII 'NEVADA' | FREMONT COTTONWOOD | 24" BOX | M         | 40-80'H X 30-50'W      |
|        | ALNUS RHOMBIFOLIA           | WHITE ALDER        | 24" BOX | H         | 50-90'H X 40-70'W      |
|        | QUERCUS AGRIFOLIA           | COAST LIVE OAK     | 24" BOX | L         | 20-70'H X 25-80'W      |

## MEDIUM ACCENT TREES (FRONT YARDS)

| SYMBOL | BOTANICAL NAME                  | COMMON NAME         | CONT   | WATER USE | MATURE HEIGHT & SPREAD |
|--------|---------------------------------|---------------------|--------|-----------|------------------------|
|        | CARPINUS BETULUS 'FASTIGIATA'   | EUROPEAN HORNBEAM   | 15 GAL | M         | 30'H X 25'W            |
|        | CERCIS CANADENSIS               | EASTERN REDBUD      | 15 GAL | M         | 25'-35'H X 25-35'W     |
|        | CRATAEGUS PHAENOPYRUM           | WASHINGTON HAWTHORN | 15 GAL | M         | 30'H X 20'W            |
|        | GINKGO BILOBA 'PRICETON SENTRY' | MAIDENHAIR TREE     | 15 GAL | M         | 45'H X 20'W            |
|        | LAURUS NOBILIS 'SARATOGA'       | SWEET BAY           | 15 GAL | L         | 30'H X 20'W            |
|        | LYONOTHAMNUS FLORIBUNDUS        | IRONWOOD            | 15 GAL | L         | 30'H X 20'W            |
|        | ROBINIA 'PURPLE ROBE'           | LOCUST              | 15 GAL | L         | 40'H X 30'W            |
|        | PISTACIA CHINENSIS              | CHINESE PISTACHE    | 15 GAL | L         | 35'H X 30'W            |

## SMALL ACCENT TREES (FRONT YARDS)

| SYMBOL | BOTANICAL NAME             | COMMON NAME       | CONT   | WATER USE | MATURE HEIGHT & SPREAD |
|--------|----------------------------|-------------------|--------|-----------|------------------------|
|        | ACER PALMATUM 'SANGO KAKU' | CORAL BARK MAPLE  | 15 GAL | M         | 25'H X 20'W            |
|        | GEIJERA PARVIFLORA         | AUSTRALIAN WILLOW | 15 GAL | L         | 25'H X 20'W            |
|        | LAGERSTROEMIA 'MUSKOGEE'   | CRAPE MYRTLE      | 15 GAL | L         | 25'H X 15'W            |
|        | MAGNOLIA X SOULANGEANA     | SAUCER MAGNOLIA   | 15 GAL | M         | 25'H X 25'W            |
|        | PRUNUS YEDOENSIS 'AKEBONO' | FLOWERING CHERRY  | 15 GAL | M         | 25'H X 25'W            |
|        | RHUS LANCEA                | AFRICAN SUMAC     | 15 GAL | L         | 20'H X 20'W            |

### PLANTING DESIGN INTENT STATEMENT

The projects shrub and ground cover planting design utilizes all low water use drought tolerant plant materials for maximum water conservation. The trees consist of a mix of primarily low and medium water use species. Some high water use native riparian trees species are utilized along the West side of the project for mitigation compliance. Shade tolerant low water use plants will be utilized on the North facing sides of the project. The plants have been selected utilizing the Model Water Efficient Landscape Ordinance WUCOLS Plant Lists. A minimum of 3" of bark mulch will be placed in all shrub and groundcover areas.

### WATER USE DESIGN INTENT STATEMENT

The irrigation system will comply with the State of California's Model Water Efficient Landscape Ordinance as adopted by the City of Oakley. System will be a fully automatic, low gallon system with matched precipitation rate emitters on each circuit. The low, medium and high water use hydrozones will be on separate valve circuits. All new trees will have separate drip or bubbler circuits. The remote control valves will have integral pressure regulators to prevent fluctuations and ensure constant application rates to minimize over or under watering. The electronic irrigation controller will be weather based and make automatic adjustments based on current climate along with multiple programs and application cycles/start times. A rain switch will be installed to prevent irrigation during rainy periods. A flow sensor and master valve will be connected to the controller to allow automatic shut off of any valve circuit or main line in the event of a pipe brake to prevent water waste.

# PLANT PALETTE

## SHRUBS

| SYMBOL | BOTANICAL NAME                       | COMMON NAME             | CONT  | WATER USE | MATURE HEIGHT & SPREAD |
|--------|--------------------------------------|-------------------------|-------|-----------|------------------------|
|        | LAVATERA ASSURGENTIFLORA             | MALLOW                  | 5 GAL | L         | 10'H X 10'W            |
|        | NANDINA DOMESTICA                    | HEAVENLY BAMBOO         | 5 GAL | L         | 6'H X 4'W              |
|        | PITTOSPORUM TOBIRA 'VARIAGATA'       | VARIAGATED TOBIRA       | 5 GAL | L         | 5'H X 5'W              |
|        | PRUNUS CAROLINIANA 'BRIGHT 'N TIGHT' | CAROLINA LAUREL         | 5 GAL | L         | 8'H X 7'W              |
|        | RHAPIOLEPIS INDICA 'SPRINGTIME'      | INDIAN HAWTHORN         | 5 GAL | L         | 5'H X 5'W              |
|        | XYLOSMA CONGESTUM                    | SHINY XYLOSMA           | 5 GAL | L         | 10'H X 10'W            |
|        | ASPIDISTRA ELATOR                    | CAST IRON PLANT         | 1 GAL | L         | 3'H X 3'W              |
|        | CEANOTHUS SPECIES                    | LILAC                   | 1 GAL | L         | 4'H X 8'W              |
|        | DIETES BICOLOR                       | FORTNIGHT LILY          | 1 GAL | L         | 3'H X 3'W              |
|        | ERYSIMUM 'BOWEL'S MAUVE'             | BOWELS MAUVE WALLFLOWER | 5 GAL | L         | 3'H X 4'W              |
|        | EURYOPS SPECIES                      | DAISY                   | 5 GAL | L         | 4'H X 4'W              |
|        | FESTUCA MAIREI                       | ATLAS FESCUE            | 1 GAL | L         | 3'H X 3'W              |
|        | GARRYA SPECIES                       | SILK TASSEL             | 5 GAL | L         | 4'H X 4'W              |
|        | GREVILLEA 'NOELI'                    | GREVILLEA               | 5 GAL | L         | 4'H X 5'W              |
|        | LAVANDULA ANGUSTIFOLIA               | ENGLISH LAVENDER        | 1 GAL | L         | 2'H X 3'W              |
|        | LOMANDRA LONGIFOLIA 'BREEZE'         | DWARF MAT RUSH          | 1 GAL | L         | 3'H X 3'W              |
|        | LORAPETALUM 'SHANG-WHITE'            | EMERALD SNOW FRINGE     | 5 GAL | L         | 4'H X 3'W              |
|        | NADINA SPECIES                       | BAMBOO                  | 1 GAL | L         | 3'H X 3'W              |
|        | PHORMIUM HYBRIDS                     | FLAX                    | 5 GAL | L         | 4'H X 3'W              |
|        | RHAPHIOLEPIS SPECIES                 | HAWTHORN                | 5 GAL | L         | 4'H X 4'W              |
|        | ROSMARINUS OFFICINALIS 'TUSCAN BLUE' | ROSEMARY                | 5 GAL | L         | 6'H X 3'W              |
|        | SALVIA SPECIES                       | SAGE                    | 5 GAL | L         | 3.5'H X 3'             |
|        | WESTRINGIA FRUTICOSA 'MORNING LIGHT' | COASTAL ROSEMARY        | 5 GAL | L         | 3.5'H X 3.5'W          |
|        | CALLISTEMON 'LITTLE JOHN'            | BOTTLE BRUSH            | 1 GAL | L         | 3'H X 3'W              |
|        | CEANOTHUS SPECIES                    | LILAC                   | 1 GAL | L         | 2'H X 8'W              |
|        | FESTUCA OVINA GLAUCA                 | BLUE FESCUE             | 1 GAL | L         | 1'H X 1'W              |
|        | LANTANA 'DWARF YELLOW'               | DWARF LANTANA           | 1 GAL | L         | 2'H X 3'W              |
|        | PHORMIUM HYBRIDS 'TONEY TIGER'       | FLAX                    | 1 GAL | L         | 2'H X 2'W              |
|        | SANTOLINA VIRENS                     | GREEN LAVENDER COTTON   | 1 GAL | L         | 2.5'H X 2.5'W          |
|        | GELSEMIUM SEMPERIENS                 | YELLOW JASMINE          | 1 GAL | L         | 15'H X 5'W             |
|        | MACFADYENA UNGUIS-CATI               | CAT'S CLAW VINE         | 1 GAL | L         | 25'H X 25'W            |

## VINES

| SYMBOL | BOTANICAL NAME         | COMMON NAME     | CONT  | WATER USE | MATURE HEIGHT & SPREAD |
|--------|------------------------|-----------------|-------|-----------|------------------------|
|        | GELSEMIUM SEMPERIENS   | YELLOW JASMINE  | 1 GAL | L         | 15'H X 5'W             |
|        | MACFADYENA UNGUIS-CATI | CAT'S CLAW VINE | 1 GAL | L         | 25'H X 25'W            |

## GROUND COVER



| SYMBOL | BOTANICAL NAME              | COMMON NAME       | CONT   | WATER USE | MATURE HEIGHT & SPREAD |
|--------|-----------------------------|-------------------|--------|-----------|------------------------|
|        | ARCTOSTAPHYLOS SPECIES      | CARPET MANZANITA  | 1 GAL  | L         | 1'H X 5'W              |
|        | ECHEVERIA SPECIES           | ECHEVERIA         | 4" POT | L         | 6"H X 6"W              |
|        | ERODIUM REICHARDII          | ALPINE GERANIUM   | 4" POT | L         | 3"H X 12"W             |
|        | CEANOTHUS SPECIES           | CALIFORNIA LILAC  | 1 GAL  | VL        | 1'H X 10'W             |
|        | CORPOSMA KRIKII 'VARIEGATA' | CREEPING CORPOSMA | 1 GAL  | L         | 1'H X 5'W              |
|        | MYOPORUM PARVIFOLIUM        | MYOPORUM          | 1 GAL  | L         | 1'H X 7'W              |
|        | SEDUM SPECIES               | STONECROP         | 4" POT | L         | 1'H X 2'W              |

## SHRUBS ALONG LITTLE DUTCH SLOUGH

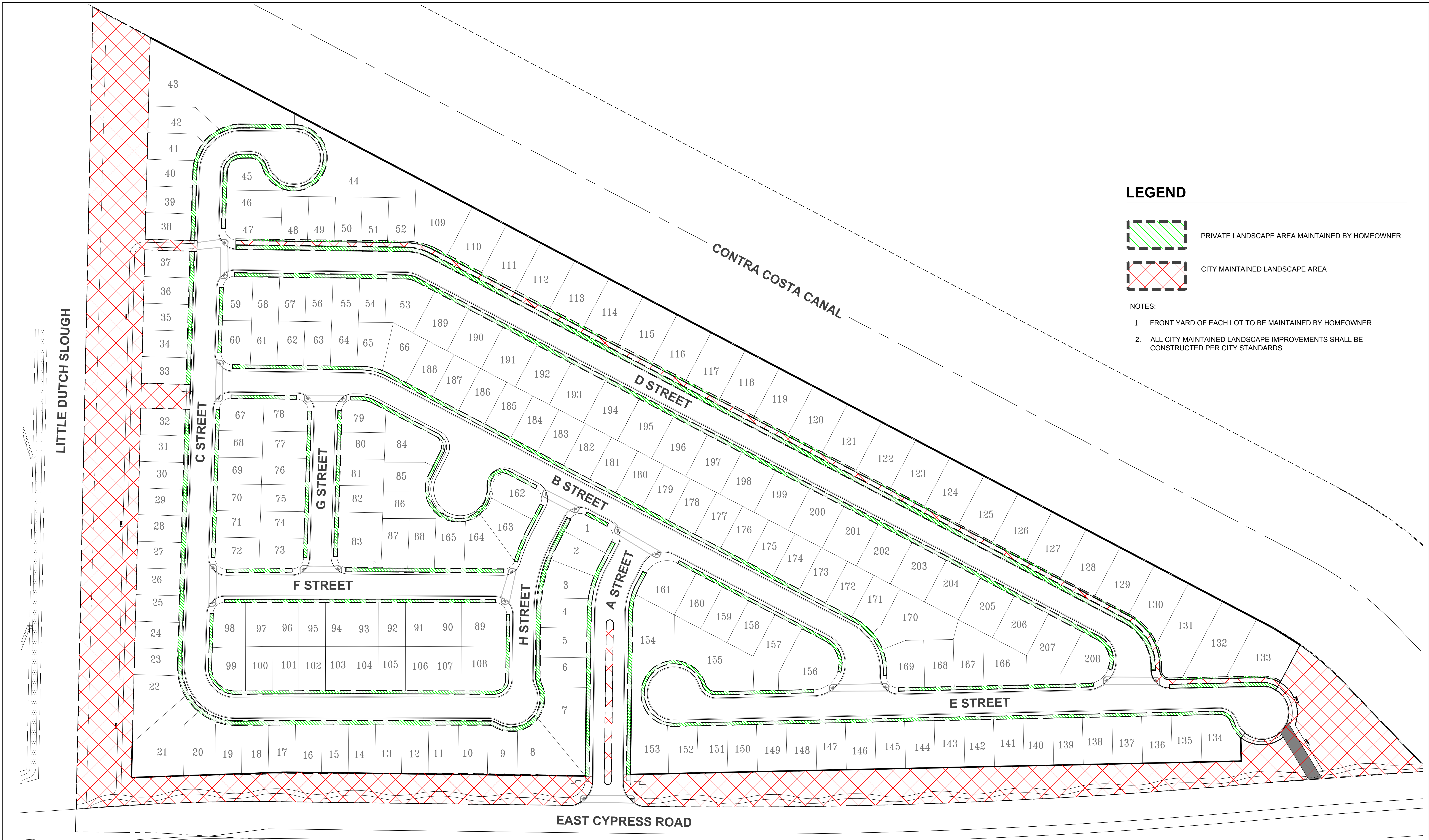
| SYMBOL | BOTANICAL NAME                        | COMMON NAME                 | CONT  | WATER USE | MATURE HEIGHT & SPREAD |
|--------|---------------------------------------|-----------------------------|-------|-----------|------------------------|
|        | ACHILLEA MILLEFOLIUM                  | YARROW                      | 1 GAL | L         | 2.5'H X 2.5'W          |
|        | ARCTOSTAPHYLOS 'JOHN DOURLY'          | JOHN DOURLY MANZANITA       | 1 GAL | L         | 2'H X 5'W              |
|        | ARCTOSTAPHYLOS 'HOWARD MCMINN'        | HOWARD MCMINN MANZANITA     | 1 GAL | L         | 7'H X 9'W              |
|        | CEANOTHUS GRISEUS VAR. 'YANKEE POINT' | YANKEE POINT CEANOTHUS      | 1 GAL | L         | 2.5'H X 9'W            |
|        | GALVESIA SPECIOSA                     | ISLAND BUSH SNAPDRAGON      | 5 GAL | L         | 3'H X 9'W              |
|        | IRIS DOUGLASIANA                      | DOUGLAS IRIS                | 1 GAL | L         | 1.5'H X 2.5'W          |
|        | LIMONIUM CALIFORNICUM                 | WESTERN MARSH ROSEMARY      | 1 GAL | L         | 2'H X 2'W              |
|        | MAHONIA REPENS                        | CREEPING OREGON GRAPE       | 1 GAL | L         | 1.5'H X 2.5'W          |
|        | MIMULUS CARDINALIS                    | SCARLET MONKEY FLOWER       | 1 GAL | L         | 2'H X 3'W              |
|        | MUHLENBERGIA RIGENS                   | DEER GRASS                  | 5 GAL | L         | 4.5'H X 5'W            |
|        | OENOTHERA CALIFORNICA                 | CALIFORNIA EVENING PRIMROSE | 5 GAL | L         | 1.5'H X 8'W            |
|        | RHAMNUS CALIFORNICA                   | ITALIAN BUCKTHORN           | 5 GAL | L         | 7'H X 6'W              |
|        | ROSA CALIFORNICA                      | CALIFORNIA WILD ROSE        | 5 GAL | L         | 9'H X 9'W              |
|        | SALVIA CLEVELANDII                    | CLEVELAND SAGE              | 5 GAL | L         | 4'H X 7'W              |
|        | SISYRINCHIUM BELLUM                   | BLUE EYED GRASS             | 1 GAL | L         | 1.5'H X 2.5'W          |
|        | ZAUSCHNERIA CALIFORNICA               | CALIFORNIA FUCHSIA          | 1 GAL | L         | 1'H X 2.5'W            |

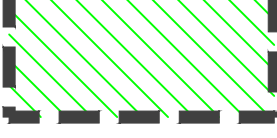

**LEGEND**

-  PRIVATE LANDSCAPE AREA MAINTAINED BY HOMEOWNER
-  CITY MAINTAINED LANDSCAPE AREA

**NOTES:**

1. FRONT YARD OF EACH LOT TO BE MAINTAINED BY HOMEOWNER
2. ALL CITY MAINTAINED LANDSCAPE IMPROVEMENTS SHALL BE CONSTRUCTED PER CITY STANDARDS

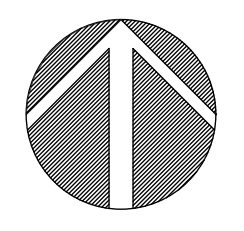

**HYDROZONE AREA CHART**

| SYMBOL                | HYDROZONE NUMBER | DESCRIPTION  | IRRIGATION METHOD | AREA SF           |
|-----------------------|------------------|--|-------------------|-------------------|
|                       | H1               | LOW WATER USE, SUN SHRUB & GC AREAS                          | DRIP              | 235,527 SF        |
|                       | H2               | MEDIUM WATER USE, SUN TREES (LOCATED IN H1 SHRUB & GC AREAS) | DRIP              | 2,088 SF          |
|                       | H3               | HIGH WATER USE, SUN TREES (LOCATED IN H1 SHRUB & GC AREAS)   | DRIP              | 444 SF            |
| <b>OVERALL TOTAL:</b> |                  |  |                   | <b>238,059 SF</b> |

**HYDROZONE DESIGN INTENT STATEMENT:**

- THE IRRIGATION SYSTEM WILL COMPLY WITH THE STATE OF CALIFORNIA'S MODEL WATER EFFICIENT LANDSCAPE ORDINANCE AS ADOPTED BY THE CITY OF OAKLEY.
- THE IRRIGATION SYSTEM WILL BE A FULLY AUTOMATIC, LOW GALLON SYSTEM WITH MATCHED PRECIPITATION RATE EMITTERS ON EACH CIRCUIT.
- THE REMOTE CONTROL VALVES WILL HAVE INTEGRAL PRESSURE REGULATORS TO PREVENT FLUCTUATIONS AND ENSURE CONSTANT APPLICATION RATES TO MINIMIZE OVER OR UNDER WATERING.
- THE ELECTRONIC IRRIGATION CONTROLLER WILL BE WEATHER BASED AND MAKE AUTOMATIC ADJUSTMENTS BASED ON CURRENT CLIMATE ALONG WITH MULTIPLE PROGRAMS AND APPLICATION CYCLES/START TIMES.
- A RAIN SWITCH WILL BE INSTALLED TO PREVENT IRRIGATION DURING RAINY PERIODS.
- A FLOW SENSOR AND MASTER VALVE WILL BE CONNECTED TO THE CONTROLLER TO ALLOW AUTOMATIC SHUT OFF OF ANY VALVE CIRCUIT OR MAIN LINE IN THE EVENT OF A PIPE BRAKE TO PREVENT WATER WASTE.
- HYDROZONE 1: CONSISTS OF ALL LOW WATER USE SHRUB AND GROUND COVER PLANT SPECIES.
- HYDROZONE 2: CONSISTS OF A MIX OF LOW AND MEDIUM WATER USE TREE SPECIES. HYDROZONE 2 IS CLASSIFIED AS MEDIUM WATER USE.
- HYDROZONE 3: CONSISTS OF HIGH WATER USE TREE SPECIES (INSTALLED PER MITIGATION REQUIREMENTS).
- THE LOW, MEDIUM AND HIGH WATER USE HYDROZONES WILL BE ON SEPARATE VALVE CIRCUITS.

**Water Efficient Landscape Worksheet:**

Project Name: Burroughs, Oakley CA

Reference Evapotranspiration (ET<sub>o</sub>): 48.3

| Hydrozone #<br>Description a  | Plant<br>Factor (PF) | Irrigation<br>Method b | Irrigation<br>Efficiency<br>(IE) c | ETAF<br>(PF/IE) | Landscape<br>Area (sq. ft.)                     | ETAF x Area         | Est. Total<br>Water Use<br>(ETWU) d |
|---|----------------------|------------------------|------------------------------------|-----------------|---|---------------------|-------------------------------------|
| <b>Regular Landscape Area Hydrozones</b>                                  |                      |                        |                                    |                 |   |                     |                                     |
| H1: Low Water Use Shrub & GC Areas  | 0.30                 | Drip                   | 0.81                               | 0.37037         | 235,527   | 87,232              | 2,612,256                           |
| H2: Medium Water Use Trees*   | 0.50                 | Drip                   | 0.81                               | 0.61728         | 2,088   | 1,289               | 38,597                              |
| H3: High Water Use Trees  | 0.70                 | Drip                   | 0.81                               | 0.86420         | 444   | 384                 | 11,490                              |
| <b>Totals</b>   |                      |                        |                                    |                 | <b>238,059</b>                                  | <b>88,905</b>       | <b>2,662,344</b>                    |
| <b>Special Landscape Area Hydrozones</b>                                  |                      |                        |                                    |                 |   |                     |                                     |
| N/A   |                      |                        |                                    | 1               |   |                     |                                     |
| N/A   |                      |                        |                                    | 1               |   |                     |                                     |
| N/A   |                      |                        |                                    | 1               |   |                     |                                     |
| <b>Totals</b>   |                      |                        |                                    |                 | <b>(C)</b>                                      | <b>(D)</b>          |                                     |
|   |                      |                        |                                    |                 |   | <b>ETWU Total d</b> | <b>2,662,344</b>                    |
| * Medium Hydrozone H2 consists of a mix of Low and Medium Water Use Trees |                      |                        |                                    |                 | <b>Maximum Allowed Water Allowance (MAWA) e</b> |                     | <b>3,920,903</b>                    |

a) Hydrozone #/Planting Description  
 E.g.  
 1) high water use turf  
 2) low water use plantings  
 3) medium water use planting

b) Irrigation Method  
 overhead spray  
 or drip

c) Irrigation Efficiency  
 0.75 for spray head  
 0.81 for drip

d) ETWU (Annual Gallons Required)  
 ET<sub>o</sub> x 0.62 x ETAF x Area where 0.62 is a conversion factor that converts acre-inches per acre per year to gallons per square foot per year; LA is the total landscape area in square feet; SLA is the total special landscape area in square feet, and ETAF is 0.55 for residential areas and 0.45 for non-residential areas.

e) MAWA (Annual Gallons Allowed) = (E<sub>o</sub>) (0.62) [(ETAF x LA) + ((1-ETAF) x SLA)]

ETAF used MAWA calculation: 0.55  
 Average ETAF for Regular Landscape Areas must be 0.55 or below for residential areas, and 0.45 or below for non-residential areas.

| ETAF Calculations       |         |
|-------------------------|---------|
| Regular Landscape Areas |         |
| Total ETAF x Area       | 88,905  |
| Total Area              | 238,059 |
| Average ETAF            | 0.37    |

| All Landscape Areas |         |
|---------------------|---------|
| Total ETAF x Area   | 88,905  |
| Total Area          | 238,059 |
| Average ETAF        | 0.37    |

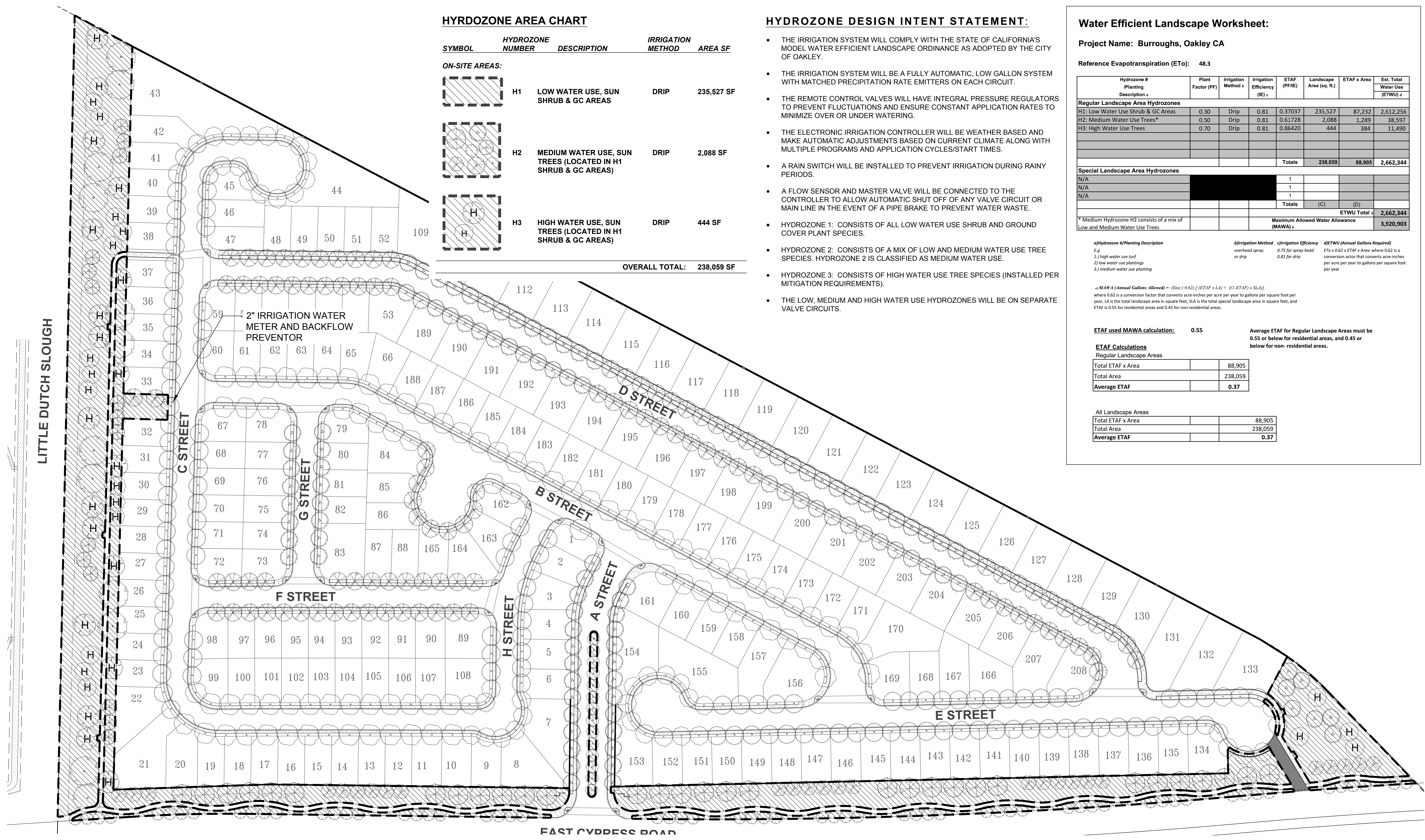

LITTLE DUTCH SLOUGH

FAST CYDESS ROAD

