



chanticleer



Teacup Garden

Map & Plant Lists • May 2024
\$2 each

Maps and plant lists may be purchased at the garden entrance or downloaded for free at chanticleergarden.org.

sun partial shade full shade



Crambe maritima

Herbaceous Perennial

Upper Border



Euphorbia amygdaloides var. robbiae

Herbaceous Perennial

Upper Border



Digitalis purpurea 'Camelot Cream'

Biennial

Teacup Garden



Geranium macrorrhizum 'Ingwersen's Variety'

Perennial

Oak Bed



Heuchera 'Black Taffeta'

Herbaceous Perennial

Entrance Pavilion and Containers



Heuchera 'Caramel'

Herbaceous Perennial

Teacup Garden



Kolkwitzia (Linnea) amabilis

Shrub

Island Beds 3 and 4



Lupinus polyphyllus 'Westcountry Masterpiece'

Biennial

Entrance Pavilion



Lupinus polyphyllus 'Westcountry™ Salmon Star'

Biennial

Teacup Garden



Rheum palmatum var. tangticum

Herbaceous Perennial

Entrance Pavilion



Viola cornuta [Sorbet XP Denim Jump Up]

Annual

Entrance Pavilion



Wisteria macrostachys

Woody Climber

Entrance Patio (bed location actually Long Border)





chanticleer



Teacup Garden

Map & Plant Lists • April 2024

\$2 each

Maps and plant lists may be purchased at the garden entrance or downloaded for free at chanticleergarden.org.

☉ sun ☉ partial shade ● full shade



Bellis perennis 'Bellissima™ Red'

Annual

Entrance Patio



Fothergilla 'Mount Airy'

Shrub

Upper Border



Geum 'Mai Tai'

Herbaceous Perennial

Teacup Garden



Helleborus x hybridus

Herbaceous Perennial

North Side and Oak Bed



Myosotis sylvatica 'Snowsylvia'

Annual

Teacup Garden



Narcissus 'Mrs. Ernst H Krelage'

Bulb

Upper Border



Narcissus 'Segovia'

Bulb

Upper Border



Phlox stolonifera 'Sherwood Purple'

Perennial

Oak Bed



Phacelia bipinnatifida

Biennial

Island Beds 1-3, Oak Bed



Primula 'SuperNova Pink'

Annual

Containers

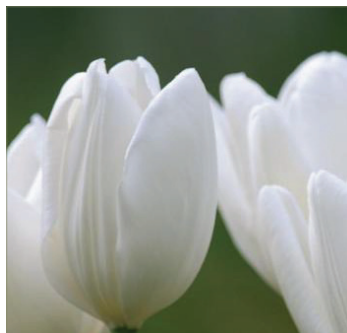

Tulipa 'Hakuun'

Bulb

Upper Border



Viola cornuta [Sorbet® XP Denim]

Annual

Entrance Patio



Teacup & Entry Gardens

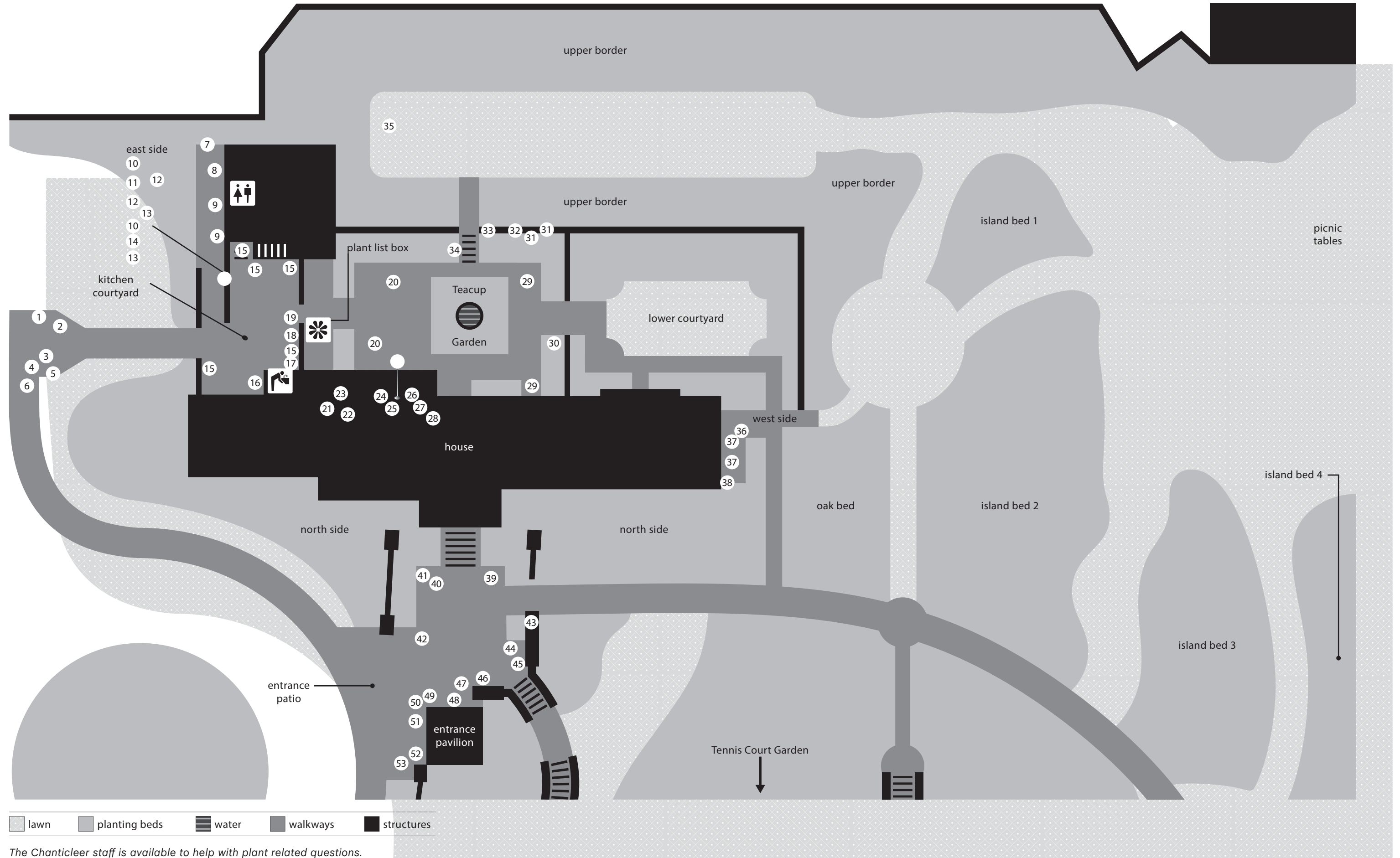

The Chanticleer staff is available to help with plant related questions.

teacup garden container list, may 2024

east side

1. Aquilegia 'Earlybird™ Blue White'
Brassica oleracea 'Stonehead'
Festuca glauca [Beyond Blue] = 'Casca11'
2. Anthriscus cerefolium
Aquilegia 'Earlybird™ Blue White'
Brassica oleracea 'Stonehead'
3. Festuca glauca [Beyond Blue] = 'Casca11'
4. Aquilegia 'Earlybird™ Blue White'
5. Aquilegia 'Earlybird™ Blue White'
Festuca glauca [Beyond Blue] =
'Casca11'
6. Aquilegia 'Earlybird™ Blue White'
Brassica oleracea 'Stonehead'
Festuca glauca [Beyond Blue] = 'Casca11'

kitchen courtyard and restrooms

7. Brassica oleracea 'Stonehead'

Chamaedorea 'Douglas Delight'
8. Brassica oleracea 'Stonehead'
Ficus carica 'Brown Turkey'
Viola cornuta [Sorbet® XP Neptune] =
'PAS1122571'
9. Brassica oleracea 'Stonehead'
Ficus carica 'Brown Turkey'
Viola cornuta [Sorbet® XP Neptune] =
'PAS1122571'
10. Festuca glauca [Beyond Blue] =
'Casca11'
Isotoma fluviatilis
Lactuca sativa 'Sandy'
Primula 'Supernova Pink'
11. Isotoma fluviatilis
Primula 'Supernova Pink'

12. Lactuca sativa 'Sandy'
Primula 'Supernova Pink'
13. Primula 'Supernova Pink'
Sagina subulata
14. Isotoma fluviatilis
Sagina subulate
15. Cyperus papyrus 'King Tut'
16. Aspidistra elatior
17. Agapanthus praecox subsp. orientalis

Side containers (subject to change or removal)

Brassica oleracea 'Stonehead'
Lactuca sativa 'Flashy Troutback'
Viola cornuta [Sorbet® Honeybee]
= 'PAS1122567'

Paeonia 'Early Scout'

18. Hanging basket and side pot

Lactuca sativa 'Flashy Troutback'
Petroselinum crispum
Viola cornuta [Sorbet® Honeybee]
= 'PAS1122567'

19. Petroselinum crispum

On table:

Viola cornuta [Sorbet® Honeybee]
= 'PAS1122567'

teacup garden

20. Cupressus sempervirens [Tiny Tower®] =
 'Monshel'
21. Aquilegia canadensis 'Little Lanterns'
 Carex buchananii 'Red Rooster'
 Taxus x media [Stonehenge Skinny®] =
 'SMNTNDPF'
22. Rhododendron arborescens var.
 gregoriana
23. Aquilegia canadensis 'Little Lanterns'
 Carex buchananii 'Red Rooster'

 Side Pot (subject to removal):

 Narcissus 'Fragrant Rose'
24. Tiarella cordifolia 'Brandywine'
25. Aquilegia canadensis 'Little Lanterns'
 Carex buchananii 'Red Rooster'
 Taxus x media [Stonehenge Skinny®] =
 'SMNTNDPF'
26. Aquilegia canadensis 'Little Lanterns'
 Taxus x media [Stonehenge Skinny®] =
 'SMNTNDPF'
27. Aquilegia canadensis 'Little Lanterns'
 Tiarella cordifolia 'Brandywine'
28. Houstonia caerulea
 Rhododendron arborescens (late white
 seedling)
29. Chamelaucium uncinatum 'My Sweet
 Sixteen'
 Lactuca sativa 'Red Sails'
30. Acanthus mollis 'Whitewater'

31. Houstonia caerulea
 Rhododendron austrinum (Escambia
 River)
32. Houstonia caerulea
 Rhododendron arborescens var.
 georgiana
33. Houstonia caerulea
 Rhododendron arborescens (late white
 seedling)
34. Allium karataviense

upper side

35. Agave americana 'Variegata'

west side

36. Carex plantaginea
37. Carex plantaginea
 Lactuca sativa 'Flashy Troutback'
 Viola cornuta [Sorbet® XP Deep Orange]
 = 'PAS117198'
38. Camellia japonica 'Kujaku Tsubaki'

entrance patio

39. Bellis perennis 'Bellissima™ Red'
 Myosotis sylvatica 'Snowsylv'
 Tiarella 'Sugar and Spice'
 Viola cornuta [Quicktime™ Mickey] =
 'PAS1305308'
40. Viola cornuta [Quicktime™ Mickey] =
 'PAS1305308'
41. Malus prunifolia var. rinki

teacup garden container list, may 2024

42. Phlox divaricata 'Chattahoochee'
Salvia officinalis 'Tricolor'
Tiarella 'Sugar and Spice'
Viola cornuta [Quicktime™ Mickey]
= 'PAS1305308'
43. Subject to removal:

Tulipa 'Yosemite'
44. Heuchera 'Black Taffeta'
Viola cornuta [Sorbet® XP Denim] =
'PAS912434'
45. Anthriscus cerefolium
Digitalis purpurea 'Camelot Cream'
Myosotis sylvatica 'Snowsylvia'
Viola cornuta [Sorbet® XP Denim] =
'PAS912434'
46. Myosotis sylvatica 'Snowsylvia'
Phlox divaricata 'Chattahoochee'
Tiarella 'Sugar and Spice'
47. Myosotis sylvatica 'Snowsylvia'
Prunus 'North Star'
Salvia officinalis 'Tricolor'
Viola cornuta [Quicktime™ Mickey]
= 'PAS1305308'
48. Bellis perennis 'Bellissima™ Red'
Myosotis sylvatica 'Snowsylvia'
Tiarella 'Sugar and Spice'
49. Bellis perennis 'Bellissima™ Red'
Salvia officinalis 'Tricolor'
Viola cornuta [Sorbet® XP Denim] =
'PAS912434'
50. Anthriscus cerefolium
Tiarella 'Sugar and Spice'
Viola cornuta [Sorbet® XP Denim] =
'PAS912434'
51. Anthriscus cerefolium
Bellis perennis 'Bellissima™ Red'
Viola cornuta [Sorbet® XP Denim] =
'PAS912434'
52. Heuchera 'Black Taffeta'
Myosotis sylvatica 'Snowsylvia'
Phlox divaricata 'Chattahoochee'
53. Anthriscus cerefolium
Salvia officinalis 'Tricolor'
Viola cornuta [Quicktime™ Mickey]
= 'PAS1305308'

entrance circle

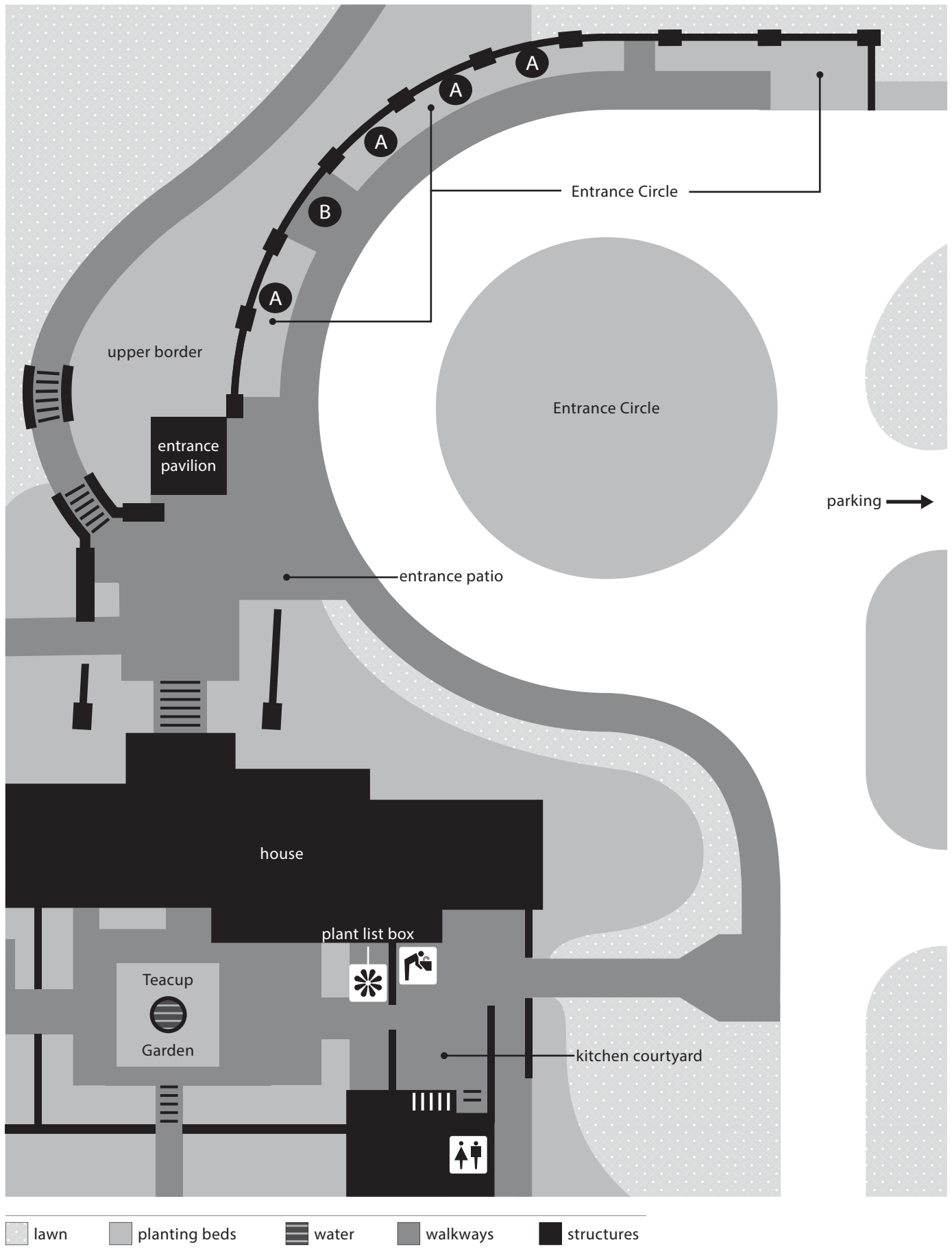

teacup garden (island beds)



lawn

planting beds

walkways

structures

garden bed plant list hardy and non-hardy plants growing in the entrance circle, teacup garden and island beds, 4/24/24

location	botanical name
East Side	Acer negundo 'Kelly's Gold'
East Side	Allium stipitatum 'Mount Everest'
East Side	Aristolochia clematitis
East Side	Asarum canadense
East Side	Betula platyphylla [First Editions® Parkland] = 'Jefpark'
East Side	Buxus sempervirens 'Dee Runk'
East Side	Buxus sempervirens 'Unraveled'
East Side	Calamagrostis x acutiflora 'Eldorado'
East Side	Carex elata 'Bowles's Golden'
East Side	Carex morrowii 'Ice Dance'
East Side	Cephalotaxus harringtonii 'Duke Gardens'
East Side	Cephalotaxus harringtonii 'Fastigiata'
East Side	Clematis 'Niobe'
East Side	Clematis x durandii
East Side	Cornus stolonifera 'Silver and Gold'
East Side	Euonymus fortunei 'Wolong Ghost'
East Side	Euphorbia epithymoides
East Side	Fagus sylvatica 'Purpurea Tricolor'
East Side	Galanthus elwesii
East Side	Galanthus elwesii (large form)
East Side	Geranium [Rozanne] = 'Gerwat'
East Side	Hakonechloa macra 'All Gold'
East Side	Hosta 'Fire Island'
East Side	Hosta sieboldiana 'Elegans'
East Side	Hydrangea 'Mountain Mania'
East Side	Hydrangea paniculata 'Praecox'
East Side	Ilex verticillata 'Winter Red' (f)
East Side	Kniphofia 'Flamenco Mix'
East Side	Leucosceptrum japonicum 'Golden Angel'
East Side	Leucosceptrum japonicum 'Silver Angel'
East Side	Ligularia japonica
East Side	Lilium 'Fusion'
East Side	Lilium henryi
East Side	Liriope spicata
East Side	Lonicera periclymenum 'Honeybush Improved'
East Side	Lonicera sempervirens 'Superba'
East Side	Narcissus 'Emcys'
East Side	Narcissus 'February Gold'
East Side	Narcissus 'Jamestown'
East Side	Narcissus 'Moonlight Sensation'
East Side	Narcissus 'Sunlight Sensation'
East Side	Narcissus 'Sweet Smiles'
East Side	Narcissus 'Tête-à-Tête'
East Side	Osmanthus heterophyllus 'Sasaba'
East Side	Pachysandra terminalis 'Green Sheen'
East Side	Penstemon 'Dark Towers'
East Side	Phlox paniculata 'Blue Paradise'
East Side	Prunus laurocerasus 'Chestnut Hill'
East Side	Rheum palmatum var. tanguticum
East Side	Rhododendron 'Mary Fleming'
East Side	Rudbeckia maxima
East Side	Salvia nemorosa 'Caradonna'
East Side	Sarcococca hookeriana var. humilis
East Side	Sarcococca hookeriana var. humilis [Fragrant Valley] = 'Sarsidl'
East Side	Sorbus alnifolia

garden bed plant list hardy and non-hardy plants growing in the entrance circle, teacup garden and island beds, 4/24/24

location	botanical name
East Side	Ulmus parvifolia
East Side	Wisteria macrostachya 'Clara Mack'
Entrance Circle	Agastache 'Blue Boa'
Entrance Circle	Allium 'Millenium'
Entrance Circle	Amsonia taberaemontana 'Blue Ice'
Entrance Circle	Aristolochia macrophylla
Entrance Circle	Buxus sempervirens 'Vardar Valley'
Entrance Circle	Carex morrowii 'Ice Dance'
Entrance Circle	Carex testacea 'Prairie Fire'
Entrance Circle	Ceanothus x delilianus 'Gloire de Versailles'
Entrance Circle	Clematis [Anna Louise] = 'Evithree'
Entrance Circle	Cotinus coggygria [Golden Spirit™] = 'Ancot'
Entrance Circle	Cotinus coggygria 'Royal Purple'
Entrance Circle	Crococsmia [Orange Pekoe] = 'Pek Or'
Entrance Circle	Crococsmia x crocosmiiflora 'George Davison '
Entrance Circle	Crococsmia x crocosmiiflora 'Norwich Canary'
Entrance Circle	Crocus biflorus 'Miss Vain'
Entrance Circle	Crocus speciosus 'Conqueror'
Entrance Circle	Eryngium planum 'Blaukappe'
Entrance Circle	Euphorbia amygdaloides var. robbiae
Entrance Circle	Fritillaria uva-vulpis
Entrance Circle	Geranium maculatum 'Espresso'
Entrance Circle	Geranium 'Nimbus'
Entrance Circle	Iris (Reticulata Hybrids Group) 'J.S. Dijt'
Entrance Circle	Lagerstroemia 'Choctaw'
Entrance Circle	Lindera salicifolia
Entrance Circle	Narcissus 'Starlight Sensation'
Entrance Circle	Osmanthus heterophyllus 'Goshiki'
Entrance Circle	Osmanthus heterophyllus 'Gulftide'
Entrance Circle	Paeonia 'Red Red Rose'
Entrance Circle	Papaver orientale var. bracteatum
Entrance Circle	Parthenium integrifolium
Entrance Circle	Penstemon 'Dark Towers'
Entrance Circle	Penstemon heterophyllus 'Blue Spring'
Entrance Circle	Perovskia atriplicifolia [Peek-A-Blue] = 'WALPPB'
Entrance Circle	Perovskia atriplicifolia 'Little Spire'
Entrance Circle	Perovskia atriplicifolia 'Rocketman'
Entrance Circle	Phlox paniculata 'Blue Paradise'
Entrance Circle	Phlox paniculata 'Jeana'
Entrance Circle	Platycodon grandiflorus 'Double Blue'
Entrance Circle	Rhamnus davuricus
Entrance Circle	Rosa 'Veilchenblau'
Entrance Circle	Sambucus racemosa [Lemony Lace] = 'SMNSRD4'
Entrance Circle	Sedum rupestre 'Angelina'
Entrance Circle	Sesleria argentea
Entrance Circle	Tulipa (Single Late Group) 'Queen of Night'
Entrance Circle	Tulipa (Triumph Group) 'Purple Lady'
Entrance Circle	Tulipa 'Best Purple'
Entrance Circle	Tulipa clusiana (Species Group) 'Tubergen's Gem'
Entrance Circle	Tulipa humilis (Species Group) 'Odalisque'
Entrance Circle	Xanthocyparis nootkatensis 'Strict Weeping'
Entrance Circle	Yucca filamentosa 'Color Guard'
Entrance Patio	Allium 'Ambassador'
Entrance Patio	Allium stipitatum 'Mount Everest'
Entrance Patio	Athyrium niponicum var. pictum

garden bed plant list hardy and non-hardy plants growing in the entrance circle, teacup garden and island beds, 4/24/24

location	botanical name	
Entrance Patio	Bellis perennis 'Bellissima™ Red'	Seasonal / Annual
Entrance Patio	Brassica rapa var. chinensis 'Rosie'	Seasonal / Annual
Entrance Patio	Buxus 'Green Velvet'	
Entrance Patio	Carex laxiculmis [Bunny Blue™] = 'Hobb'	
Entrance Patio	Carex testacea 'Prairie Fire'	
Entrance Patio	Clematis 'Madame Julia Correvon'	
Entrance Patio	Clematis 'Niobe'	
Entrance Patio	Dicentra 'Ivory Hearts'	
Entrance Patio	Digitalis purpurea 'Camelot Cream'	Seasonal / Biennial
Entrance Patio	Digitalis purpurea 'Camelot Lavender'	Seasonal / Biennial
Entrance Patio	Erysimum 'Sugar Rush™ Purple Bicolor'	Seasonal / Annual
Entrance Patio	Erysimum 'Sugar Rush™ Yellow'	Seasonal / Annual
Entrance Patio	Euphorbia epithymoides 'Bonfire'	
Entrance Patio	Geum 'Mai Tai'	Seasonal / Hardy
Entrance Patio	Helleborus x hybridus 'Winter Jewels® Peppermint Ice'	
Entrance Patio	Heuchera 'Black Taffeta'	Seasonal / Hardy
Entrance Patio	Heuchera 'Caramel'	Seasonal / Hardy
Entrance Patio	Heuchera 'Midnight Bayou'	
Entrance Patio	Iberis sempervirens 'Snowsurfer™ Forte'	
Entrance Patio	Lupinus polyphyllus 'Westcountry™ Salmon Star'	Seasonal / Annual
Entrance Patio	Mysotis sylvatica 'Snowsyla'	Seasonal / Annual
Entrance Patio	Phlox divaricata 'Chattahoochee'	Seasonal / Hardy
Entrance Patio	Salvia officinalis 'Tricolor'	Seasonal / Hardy
Entrance Patio	Tiarella 'Sugar and Spice'	Seasonal / Hardy
Entrance Patio	Tulipa (Single Late Group) 'Yosemite'	
Entrance Patio	Viola cornuta [Quicktime™ Mickey] = 'PAS1305308'	Seasonal / Annual
Entrance Patio	Viola cornuta [Sorbet® XP Denim] = 'PAS912434'	Seasonal / Annual
Island Bed 1	Ajuga reptans [Chocolate Chip] = 'Valfredda'	
Island Bed 1	Allium 'Graceful'	
Island Bed 1	Allium stipitatum 'Mount Everest'	
Island Bed 1	Allium stipitatum 'White Giant'	
Island Bed 1	Amsonia taberaemontana 'Blue Ice'	
Island Bed 1	Andropogon gerardii 'Rain Dance'	
Island Bed 1	Anemone [Fantasy™ Snow Angel] = 'Ifansa'	
Island Bed 1	Anemone blanda 'White Splendour'	
Island Bed 1	Anemone x hybrida	
Island Bed 1	Bergenia 'Bressingham Ruby'	
Island Bed 1	Buxus sempervirens 'Dee Runk'	
Island Bed 1	Calamagrostis x acutiflora 'Karl Foerster'	
Island Bed 1	Callicarpa japonica 'Duet'	
Island Bed 1	Carex appalachica	
Island Bed 1	Carex eburnea	
Island Bed 1	Caryopteris x clandonensis 'White Surprise'	
Island Bed 1	Chionodoxa	
Island Bed 1	Chionodoxa forbesii	
Island Bed 1	Chionodoxa forbesii 'Blue Giant'	
Island Bed 1	Chionodoxa luciliae	
Island Bed 1	Chionodoxa sardensis	
Island Bed 1	Clematis [Blue Pirouette] = 'Zobluepi'	
Island Bed 1	Clematis integrifolia	
Island Bed 1	Clematis 'Whoopi'	
Island Bed 1	Clematis x triternata 'Rubro-marginata'	
Island Bed 1	Colchicum autumnale 'Album'	
Island Bed 1	Colchicum speciosum 'Album'	
Island Bed 1	Cornus florida var. pringlei	

garden bed plant list hardy and non-hardy plants growing in the entrance circle, teacup garden and island beds, 4/24/24

location	botanical name
Island Bed 1	Corylopsis 'Winterthur'
Island Bed 1	Cotinus coggygria Purpureus Group
Island Bed 1	Cotinus coggygria 'Velvet Cloak'
Island Bed 1	Crinum bulbispermum
Island Bed 1	Crocus chrysanthus
Island Bed 1	Daphne caucasica
Island Bed 1	Daphne x transatlantica [Eternal Fragrance] = 'Blafra'
Island Bed 1	Datisca cannabina
Island Bed 1	Echinacea 'Cheyenne Spirit'
Island Bed 1	Exochorda [Snow Day® Surprise] = 'Niagara'
Island Bed 1	Fritillaria raddeana
Island Bed 1	Galanthus nivalis
Island Bed 1	Geranium x oxonianum
Island Bed 1	Gladiolus 'Boone'
Island Bed 1	Hemerocallis 'Night Embers'
Island Bed 1	Hemerocallis 'September Sol'
Island Bed 1	Heuchera americana 'Dale's Strain'
Island Bed 1	Heuchera 'Montrose Ruby'
Island Bed 1	Hibiscus 'Raspberry Rose'
Island Bed 1	Hyacinthus orientalis 'Blue Festival'
Island Bed 1	Hydrangea bretschneideri
Island Bed 1	Hydrangea paniculata [Pink Diamond] = 'Interhydia'
Island Bed 1	Hydrangea paniculata 'Tardiva'
Island Bed 1	Hypericum androsaemum 'Albury Purple'
Island Bed 1	Kirengeshoma palmata Koreana Group
Island Bed 1	Kniphofia 'Flamenco Mix'
Island Bed 1	Leptodermis oblonga
Island Bed 1	Leucanthemum x superbum 'Goldfinch'
Island Bed 1	Leucosceptrum japonicum 'Golden Angel'
Island Bed 1	Liatris gracilis
Island Bed 1	Lunaria annua
Island Bed 1	Lycoris squamigera
Island Bed 1	Magnolia 'Randy'
Island Bed 1	Muhlenbergia capillaris
Island Bed 1	Paeonia lactiflora 'Festiva Maxima'
Island Bed 1	Paeonia lactiflora 'Lady Alexandra Duff'
Island Bed 1	Paeonia 'Nosegay'
Island Bed 1	Paeonia 'Prairie Moon'
Island Bed 1	Papaver orientale 'Prinzessin Victoria Louise'
Island Bed 1	Phacelia bipinnatifida
Island Bed 1	Phlox carolina 'Miss Lingard'
Island Bed 1	Phlox paniculata 'Jeana'
Island Bed 1	Phlox stolonifera 'Blue Ridge'
Island Bed 1	Pulmonaria 'Raspberry Splash'
Island Bed 1	Pulmonaria 'Silver Bouquet'
Island Bed 1	Rheum palmatum var. tanguticum
Island Bed 1	Rhododendron 'Rosy Lights'
Island Bed 1	Salix fargesii
Island Bed 1	Sambucus nigra [Black Lace™] = 'Eva'
Island Bed 1	Schizachyrium scoparium 'The Blues'
Island Bed 1	Scilla siberica
Island Bed 1	Sedum 'Frosty Morn'
Island Bed 1	Silene armeria
Island Bed 1	Tinantia pringlei
Island Bed 1	Ulmus x hollandica 'Dampieri Aurea'

garden bed plant list hardy and non-hardy plants growing in the entrance circle, teacup garden and island beds, 4/24/24

location	botanical name
Island Bed 1	Vaccinium corymbosum [Peach Sorbet®] = 'ZF06-043'
Island Bed 1	Veronica umbrosa 'Georgia Blue'
Island Bed 1	Waldsteinia fragarioides
Island Bed 2	Allium 'Ambassador'
Island Bed 2	Allium stipitatum 'White Giant'
Island Bed 2	Amsonia taberaemontana 'Blue Ice'
Island Bed 2	Anemone [Fantasy™ Snow Angel] = 'Ifansa'
Island Bed 2	Bellevia paradoxa
Island Bed 2	Calamagrostis x acutiflora 'Karl Foerster'
Island Bed 2	Caryopteris x clandonensis 'White Surprise'
Island Bed 2	Chionodoxa forbesii
Island Bed 2	Chionodoxa luciliae
Island Bed 2	Chionodoxa sardensis
Island Bed 2	Clethra barbinervis [FIRST SNOW] = 'Takeda Nishiki'
Island Bed 2	Cornus alternifolia
Island Bed 2	Crocsmia 'Emberglow'
Island Bed 2	Echinacea tenesseeensis 'Rocky Top'
Island Bed 2	Eryngium 'Big Blue'
Island Bed 2	Festuca glauca [Beyond Blue] = 'Casca11'
Island Bed 2	Geranium 'Nimbus'
Island Bed 2	Helleborus (Rodney Davey Marbled Group) 'Anna's Red'
Island Bed 2	Heuchera 'Obsidian'
Island Bed 2	Hosta sieboldiana
Island Bed 2	Lilium 'Orange Marmalade'
Island Bed 2	Nepeta x faassenii 'Six Hills Giant'
Island Bed 2	Paeonia ostii
Island Bed 2	Paeonia suffruticosa 'Kaoukamon'
Island Bed 2	Papaver orientale 'Prinzessin Victoria Louise'
Island Bed 2	Persicaria microcephala 'Red Dragon'
Island Bed 2	Rhododendron 'Rosy Lights'
Island Bed 2	Stachys byzantina 'Countess Helene von Stein'
Island Bed 2	Tulipa (Single Late Group) 'Menton'
Island Bed 2	Tulipa clusiana (Species Group) 'Lady Jane'
Island Bed 2	Viburnum plicatum f. tomentosum 'Molly Schroeder'
Island Bed 2	Weigela [Tuxedo™] = 'Velda'
Island Bed 3	Brunnera macrophylla
Island Bed 3	Carex cherokeensis
Island Bed 3	Carex pensylvanica
Island Bed 3	Carex socialis
Island Bed 3	Chionodoxa forbesii
Island Bed 3	Chionodoxa luciliae
Island Bed 3	Chionodoxa sardensis
Island Bed 3	Clematis [Amethyst Beauty] = 'Evipo043'
Island Bed 3	Corylopsis 'Winterthur'
Island Bed 3	Crocsmia 'Emberglow'
Island Bed 3	Daphne caucasica
Island Bed 3	Daphniphyllum himalaense ssp. macropodium
Island Bed 3	Deschampsia cespitosa 'Goldtau'
Island Bed 3	Echinacea purpurea 'Virgin'
Island Bed 3	Epimedium pubigerum
Island Bed 3	Epimedium x versicolor 'Sulphureum'
Island Bed 3	Geranium x oxonianum
Island Bed 3	Hosta
Island Bed 3	Hosta (un-named)
Island Bed 3	Hyacinthus orientalis 'Blue Festival'

garden bed plant list hardy and non-hardy plants growing in the entrance circle, teacup garden and island beds, 4/24/24

location	botanical name
Island Bed 3	Hydrangea macrophylla [Endless Summer®] = 'Blushing Bride'
Island Bed 3	Hydrangea macrophylla 'Ayesha'
Island Bed 3	Hydrangea serrata (Wilson 7820)
Island Bed 3	Hydrangea serrata 'Blue Billow'
Island Bed 3	Illicium floridanum 'Hally's Comet'
Island Bed 3	Juglans nigra
Island Bed 3	Kniphofia northiae
Island Bed 3	Kolkwitzia amabilis
Island Bed 3	Lamprocapnos spectabilis 'Alba'
Island Bed 3	Lilium formosanum var. pricei
Island Bed 3	Lilium lancifolium
Island Bed 3	Lilium martagon 'Russian Morning'
Island Bed 3	Liriope muscari
Island Bed 3	Magnolia acuminata
Island Bed 3	Muscari armeniacum
Island Bed 3	Narcissus 'Rip van Wrinkle'
Island Bed 3	Paeonia 'Cora Louise'
Island Bed 3	Paeonia 'Old Rose Dandy'
Island Bed 3	Perovskia atriplicifolia 'Little Spire'
Island Bed 3	Philadelphus 'Virginal'
Island Bed 3	Physocarpus opulifolius [Diabolo®] = 'Monlo'
Island Bed 3	Pycnanthemum muticum
Island Bed 3	Rhododendron degronianum ssp. yakushmanum 'Ken Janeck'
Island Bed 3	Sambucus nigra [Black Lace™] = 'Eva'
Island Bed 3	Silene armeria
Island Bed 3	Spiraea nipponica 'Snowmound'
Island Bed 3	Sporobolus heterolepis 'Tara'
Island Bed 3	Symphotrichum ericoides var. ericoides 'Snow Flurry'
Island Bed 3	Syringa vulgaris (large, single pink)
Island Bed 3	Syringa vulgaris (purple-leaved)
Island Bed 3	Syringa x henryi
Island Bed 3	Thujopsis dolabrata 'Nana'
Island Bed 3	Weigela florida 'Variegata'
Island Bed 4	Carex cherokeensis
Island Bed 4	Carex pensylvanica
Island Bed 4	Carex socialis
Island Bed 4	Chionodoxa forbesii
Island Bed 4	Chionodoxa luciliae
Island Bed 4	Chionodoxa sardensis
Island Bed 4	Corylopsis 'Winterthur'
Island Bed 4	Daphniphyllum himalaense ssp. macropodium
Island Bed 4	Dryopteris erythrosora 'Brilliance'
Island Bed 4	Dryopteris x australis
Island Bed 4	Echinacea purpurea 'Virgin'
Island Bed 4	Epimedium x versicolor 'Sulphureum'
Island Bed 4	Eragrostis spectabilis
Island Bed 4	Geranium x oxonianum
Island Bed 4	Hydrangea macrophylla [Endless Summer®] = 'Blushing Bride'
Island Bed 4	Hydrangea serrata 'Blue Billow'
Island Bed 4	Illicium floridanum 'Hally's Comet'
Island Bed 4	Illicium floridanum 'Shady Lady'
Island Bed 4	Kolkwitzia amabilis 'Pink Cloud'
Island Bed 4	Lilium martagon 'Russian Morning'
Island Bed 4	Liriope muscari
Island Bed 4	Muscari armeniacum

garden bed plant list hardy and non-hardy plants growing in the entrance circle, teacup garden and island beds, 4/24/24

location	botanical name
Island Bed 4	Narcissus 'Rip van Wrinkle'
Island Bed 4	Pieris japonica
Island Bed 4	Pycnanthemum muticum
Island Bed 4	Rhododendron maximum 'Roseum'
Island Bed 4	Rhododendron 'Scintillation'
Island Bed 4	Silene armeria
Island Bed 4	Sporobolus heterolepis 'Tara'
Island Bed 4	Thujopsis dolabrata 'Nana'
Island Bed 4	Trochodendron aralioides
Island Bed 4	Weigela florida 'Variegata'
Lower Courtyard	Adiantum pedatum
Lower Courtyard	Alstroemeria 'Golden Tiara'
Lower Courtyard	Amorphophallus konjac
Lower Courtyard	Anemone blanda 'Blue Shades'
Lower Courtyard	Anemone blanda 'White Splendour'
Lower Courtyard	Aristolochia clematitis
Lower Courtyard	Asarum europaeum
Lower Courtyard	Aucuba japonica 'Hosoba Hoshifu'
Lower Courtyard	Aucuba japonica 'Mr. Wonderful'
Lower Courtyard	Aucuba japonica 'Rozannie'
Lower Courtyard	Aucuba japonica 'Suruga Benten'
Lower Courtyard	Buddleja globosa
Lower Courtyard	Buxus microphylla 'Wanford Page'
Lower Courtyard	Camellia 'Winter's Snowman'
Lower Courtyard	Cardamine quinquefolia
Lower Courtyard	Carex oshimensis 'Evercolor Everillo'
Lower Courtyard	Carex socialis
Lower Courtyard	Cercidiphyllum japonicum 'Tidal Wave'
Lower Courtyard	Chionodoxa luciliae
Lower Courtyard	Clematis 'Niobe'
Lower Courtyard	Cornus florida
Lower Courtyard	Crocus tommasinianus 'Whitewell Purple'
Lower Courtyard	Cyrtomium fortunei 'Ulleung Island'
Lower Courtyard	Danae racemosa
Lower Courtyard	Daphne odora
Lower Courtyard	Daphne odora 'Aureomarginata'
Lower Courtyard	Daphniphyllum himalaense ssp. macropodium
Lower Courtyard	Disporopsis pernyi
Lower Courtyard	Disporopsis pernyi Bill Baker Form
Lower Courtyard	Disporum longistylum 'Green Giant'
Lower Courtyard	Disporum sessile 'Variegatum'
Lower Courtyard	Dracunculus vulgaris
Lower Courtyard	Dryopteris crassirhizoma
Lower Courtyard	Edgeworthia chrysantha
Lower Courtyard	Galanthus elwesii Hiemalis Group
Lower Courtyard	Galanthus 'Ophelia'
Lower Courtyard	Hakonechloa macra 'All Gold'
Lower Courtyard	Hakonechloa macra 'Aureola'
Lower Courtyard	Hedera helix 'Duckfoot'
Lower Courtyard	Hosta 'Halcyon'
Lower Courtyard	Hosta 'Hyuga Urajiro'
Lower Courtyard	Hosta 'Komodo Dragon'
Lower Courtyard	Hosta 'Snake Eyes'
Lower Courtyard	Hosta 'Sum & Substance'
Lower Courtyard	Hydrangea anomala ssp. petiolaris

garden bed plant list hardy and non-hardy plants growing in the entrance circle, teacup garden and island beds, 4/24/24

location	botanical name
Lower Courtyard	Hydrangea anomala ssp. petiolaris 'Sutter's Mill'
Lower Courtyard	Illicium anisatum 'Murasaki-no-sato'
Lower Courtyard	Illicium henryi
Lower Courtyard	Illicium simonsii
Lower Courtyard	Illicium 'Woodland Ruby'
Lower Courtyard	Impatiens omeiana 'High Voltage'
Lower Courtyard	Iris 'Aicho-no-kagayaki'
Lower Courtyard	Iris x ampliflora 'Ming Treasure'
Lower Courtyard	Jasminum humile
Lower Courtyard	Jasminum nudiflorum
Lower Courtyard	Leucothoe fontanesiana 'Nana'
Lower Courtyard	Ligularia japonica 'Chinese Dragon'
Lower Courtyard	Lilium leichtlinii
Lower Courtyard	Lilium rubellum
Lower Courtyard	Lilium 'Satisfaction'
Lower Courtyard	Lycoris radiata 'Plenum'
Lower Courtyard	Musa basjoo
Lower Courtyard	Muscari armeniacum
Lower Courtyard	Narcissus 'Hawera'
Lower Courtyard	Narcissus 'Sunlight Sensation'
Lower Courtyard	Narcissus 'W.P. Milner'
Lower Courtyard	Ophiopogon japonicus 'Nanus'
Lower Courtyard	Osmanthus fragrans var. aurantiacus 'Beni Kin Mokusei'
Lower Courtyard	Osmunda cinnamomea
Lower Courtyard	Polygonatum odoratum var. pluriflorum 'JInguji'
Lower Courtyard	Polystichum makinoi
Lower Courtyard	Polystichum polyblepharum
Lower Courtyard	Rhapidophyllum hystrix
Lower Courtyard	Rohdea japonica
Lower Courtyard	Rohdea japonica 'Claudia Phelps'
Lower Courtyard	Sambucus racemosa [Lemony Lace] = 'SMNSRD4'
Lower Courtyard	Sarcococca confusa
Lower Courtyard	Sarcococca orientalis
Lower Courtyard	Schefflera delavayi
Lower Courtyard	Schizophragma hydrangeoides 'Moonlight'
Lower Courtyard	Schizophragma integrifolium
Lower Courtyard	Spigelia marilandica 'Little Redhead'
Lower Courtyard	Trachycarpus fortunei
Lower Courtyard	Tricyrtis formosana 'Autumn Glow'
North Side	Acer oliverianum ssp. oliverianum
North Side	Ajuga reptans [Chocolate Chip] = 'Valfredda'
North Side	Allium stipitatum 'Mount Everest'
North Side	Anemone blanda 'White Splendour'
North Side	Aquilegia canadensis 'Little Lanterns'
North Side	Camellia japonica
North Side	Camellia japonica 'Bloomfield'
North Side	Camellia japonica 'Longwood Valentine'
North Side	Camellia japonica 'National Arboretum Pink'
North Side	Camellia oleifera
North Side	Camellia 'Winter's Joy'
North Side	Camellia 'Winter's Snowman'
North Side	Cercis chinensis 'Avondale'
North Side	Chamaecyparis obtusa 'Compacta'
North Side	Chamaecyparis obtusa 'Gracilis'
North Side	Chamaecyparis obtusa 'Kosteri'

garden bed plant list hardy and non-hardy plants growing in the entrance circle, teacup garden and island beds, 4/24/24

location	botanical name
North Side	Chamaecyparis obtusa 'Nana Gracilis'
North Side	Chionodoxa forbesii
North Side	Chionodoxa luciliae
North Side	Chionodoxa sardensis
North Side	Chrysogonum virginianum
North Side	Cladrastis kentukea
North Side	Clematis 'Diamond Ball'
North Side	Clematis 'Duchess of Albany'
North Side	Corylopsis sinensis
North Side	Cotinus coggygria 'Royal Purple'
North Side	Daphniphyllum humile
North Side	Daphniphyllum macropodum
North Side	Dicentra 'Luxuriant'
North Side	Fothergilla gardenii 'Blue Mist'
North Side	Fothergilla x intermedia 'Blue Shadow'
North Side	Galanthus elwesii
North Side	Galium odoratum
North Side	Geranium [Patricia] = 'Bremplat '
North Side	Hakonechloa macra 'All Gold'
North Side	Helleborus orientalis
North Side	Helleborus x hybridus (Pine Knot Select Strain Mix)
North Side	Helleborus x hybridus (Pine Knot Select Strain Yellow)
North Side	Helleborus x hybridus 'Blue Lady'
North Side	Helleborus x hybridus 'Confetti Cake'
North Side	Helleborus x hybridus 'Dark and Handsome'
North Side	Helleborus x hybridus 'Double Vision'
North Side	Helleborus x hybridus 'Heronwood Double'
North Side	Helleborus x hybridus 'HONEYMOON™ New York Night'
North Side	Helleborus x hybridus 'White Lady'
North Side	Helleborus x hybridus 'Winter Dream Black'
North Side	Helleborus x hybridus 'Winter Jewels® Painted Doubles '
North Side	Heuchera 'Chocolate Ruffles'
North Side	Hosta 'Carolyn's Gold'
North Side	Hosta 'Carolyn's Little Nicky'
North Side	Hosta 'Emerald Tiara'
North Side	Hosta 'Malex'
North Side	Hosta plantaginea
North Side	Hosta 'Roger's Gift'
North Side	Hosta sieboldiana
North Side	Hydrangea anomala ssp. petiolaris 'Brookside Littleleaf'
North Side	Hydrangea arborescens 'Hayes Starburst'
North Side	Hydrangea aspera
North Side	Hydrangea macrophylla [Cityline™ Berlin] = 'Berlin Rabe'
North Side	Hydrangea macrophylla [Cityline™ Venice] = 'Venice Raven'
North Side	Hydrangea macrophylla 'Nachtigall'
North Side	Hydrangea 'Preziosa'
North Side	Ilex glabra [Gem Box®] = 'SMNIGAB17'
North Side	Ilex opaca (f)
North Side	Ilex x meservae
North Side	Ilex x meserveae 'Blue Prince' (m)
North Side	Ilex x meserveae 'Blue Princess' (f)
North Side	Itea virginica 'Henry's Garnet'
North Side	Lagerstroemia 'Choctaw'
North Side	Leucojum aestivum
North Side	Leucosceptrum japonicum 'Golden Angel'

garden bed plant list hardy and non-hardy plants growing in the entrance circle, teacup garden and island beds, 4/24/24

location	botanical name
North Side	Lilium 'Robina'
North Side	Lilium 'Star Gazer'
North Side	Liriope muscari 'Gold-banded'
North Side	Liriope spicata
North Side	Lonicera sempervirens 'John Clayton'
North Side	Lychnis coronaria
North Side	Magnolia virginiana
North Side	Mahonia bealei
North Side	Muscari armeniacum 'Siberian Tiger'
North Side	Nicotiana 'Stonecrop Mauve'
North Side	Orixa japonica 'Pearl Frost'
North Side	Osmanthus armatus
North Side	Paeonia 'Bartzella'
North Side	Paeonia 'Coral Charm'
North Side	Perilla frutescens 'Atropurpurea'
North Side	Philadelphus coronarius 'Aureus'
North Side	Phlox paniculata 'Blue Paradise'
North Side	Phlox stolonifera 'Sherwood Purple'
North Side	Polygonatum odoratum 'Variegatum'
North Side	Polystichum acrostichoides
North Side	Pulmonaria saccharata 'Spilled Milk'
North Side	Rheum palmatum var. tanguticum
North Side	Rhododendron 'Lemon Lights'
North Side	Rhododendron stenopetalum 'Linearifolium'
North Side	Rhododendron vaseyi 'White Find'
North Side	Rhododendron 'Weston's Lemon Drop'
North Side	Rhododendron 'White Lights'
North Side	Schizophragma corylieum
North Side	Schizophragma hydrangeoides 'Moonlight'
North Side	Schizophragma hydrangeoides 'Roseum'
North Side	Schizophragma integrifolium
North Side	Scilla siberica
North Side	Tiarella 'Spring Symphony'
North Side	Tiarella 'Timbuktu'
North Side	Tricyrtis formosana
North Side	Tulipa (Darwin Hybrid Group) 'Hakuun'
North Side	Viburnum carlesii var. bitchiuense
North Side	Vinca minor 'Illumination'
Oak Bed	Amsonia ciliata
Oak Bed	Amsonia montana f. alba
Oak Bed	Anemone blanda 'White Splendour'
Oak Bed	Anemone nemorosa 'Bracteata Pleniflora'
Oak Bed	Bergenia 'Bressingham Ruby'
Oak Bed	Bergenia ciliata f. ciliata
Oak Bed	Bulbocodium vernum
Oak Bed	Buxus microphylla var. japonica 'Morris Midget'
Oak Bed	Carex eburnea
Oak Bed	Chionodoxa forbesii
Oak Bed	Chionodoxa luciliae
Oak Bed	Chionodoxa sardensis
Oak Bed	Convallaria majalis 'Fernwood's Golden Slippers'
Oak Bed	Convallaria majalis 'Flore Pleno'
Oak Bed	Epimedium x youngianum 'Niveum'
Oak Bed	Fritillaria thunbergii
Oak Bed	Geranium macrorrhizum 'Ingwersen's Variety'

garden bed plant list hardy and non-hardy plants growing in the entrance circle, teacup garden and island beds, 4/24/24

location	botanical name	
Oak Bed	Hakonechloa macra 'All Gold'	
Oak Bed	Hakonechloa macra 'Aureola'	
Oak Bed	Helleborus (Rodney Davey Marbled Group) 'Anna's Red'	
Oak Bed	Helleborus 'Snow White'	
Oak Bed	Helleborus x hybridus 'Double Integrity'	
Oak Bed	Helleborus x hybridus 'Kingston Cardinal'	
Oak Bed	Helleborus x nigercors 'Green Heron'	
Oak Bed	Heuchera 'Montrose Ruby'	
Oak Bed	Hyacinthus orientalis 'Blue Festival'	
Oak Bed	Iris 'Aicho-no-kagayaki'	
Oak Bed	Leucojum aestivum	
Oak Bed	Lilium (African Queen Strain)	
Oak Bed	Meehania cordata	
Oak Bed	Paeonia emodi	
Oak Bed	Paeonia obovata var. willmottiae	
Oak Bed	Phacelia bipinnatifida	
Oak Bed	Phlox stolonifera 'Sherwood Purple'	
Oak Bed	Polygonatum biflorum	
Oak Bed	Quercus x saulii	
Oak Bed	Tiarella 'Sugar and Spice'	
Oak Bed	Waldsteinia fragarioides	
Tea Cup Garden	Acanthus mollis 'Whitewater'	Seasonal / Tender
Tea Cup Garden	Actaea 'Chocoholic'	
Tea Cup Garden	Actinidia tetramera var. maloides	
Tea Cup Garden	Agastache 'Blue Boa'	
Tea Cup Garden	Ajuga reptans [Black Scallop] = 'Binblasca'	Seasonal / Hardy
Tea Cup Garden	Ajuga reptans 'Chocolate Chip'	
Tea Cup Garden	Allium 'Ambassador'	
Tea Cup Garden	Allium 'Pinball Wizard'	
Tea Cup Garden	Allium sphaerocephalum	
Tea Cup Garden	Allium stipitatum 'Mars'	
Tea Cup Garden	Allium stipitatum 'Mount Everest'	
Tea Cup Garden	Allium stipitatum 'White Giant'	
Tea Cup Garden	Allium zebdanense	
Tea Cup Garden	Amorphophallus konjac	
Tea Cup Garden	Armeria maritima 'Splendens'	Seasonal / Tender
Tea Cup Garden	Arundo donax 'Variegata'	
Tea Cup Garden	Asparagus denticulatus	
Tea Cup Garden	Aster sp.	
Tea Cup Garden	Bellis perennis 'Habanera Mix'	Seasonal / Annual
Tea Cup Garden	Beta vulgaris 'Red Ruby'	Seasonal / Annual
Tea Cup Garden	Brassica juncea	Seasonal / Annual
Tea Cup Garden	Brassica oleracea Acephala Group 'Casper'	Seasonal / Annual
Tea Cup Garden	Brunnera macrophylla 'Alexander's Giant'	
Tea Cup Garden	Bulbine frutescens 'Yellow Rocket'	Seasonal / Tender
Tea Cup Garden	Buxus sinica var. insularis 'Wintergreen'	
Tea Cup Garden	Callistemon 'Clemson Hardy'	
Tea Cup Garden	Carex buchananii 'Red Rooster'	Seasonal / Hardy
Tea Cup Garden	Carex buchananii 'Red Rooster'	
Tea Cup Garden	Carex 'ColorGrass® Amazon Mist'	
Tea Cup Garden	Carex 'ColorGrass® Amazon Mist'	Seasonal / Hardy
Tea Cup Garden	Carex oshimensis 'Evergold'	
Tea Cup Garden	Carpinus betulus 'Columnaris Nana'	
Tea Cup Garden	Clematis 'Royal Velours'	
Tea Cup Garden	Clematis 'Sweet Summer Love'	

garden bed plant list hardy and non-hardy plants growing in the entrance circle, teacup garden and island beds, 4/24/24

location	botanical name	
Tea Cup Garden	Cornus sericea 'Bud's Yellow'	
Tea Cup Garden	Digitalis purpurea 'Camelot Cream'	Seasonal / Biennial
Tea Cup Garden	Digitalis purpurea 'Dalmation Peach'	Seasonal / Biennial
Tea Cup Garden	Eremurus 'Spring Valley Hybrids'	
Tea Cup Garden	Eryngium planum 'Blue Glitter'	
Tea Cup Garden	Eucomis comosa	
Tea Cup Garden	Euphorbia epithymoides 'Bonfire'	
Tea Cup Garden	Euphorbia rigida	
Tea Cup Garden	Euphorbia x martinii 'Ascot Rainbow'	
Tea Cup Garden	Fritillaria persica	
Tea Cup Garden	Geum [Totally Tangerine]	
Tea Cup Garden	Geum 'Mai Tai'	Seasonal / Hardy
Tea Cup Garden	Gladiolus 'Boone'	
Tea Cup Garden	Hakonechloa macra 'Beni Kaze'	Seasonal / Hardy
Tea Cup Garden	Hedychium coronarium	
Tea Cup Garden	Helleborus x ballardiae [Gold Collection® Pink Frost] = 'HGC Pink Frost'	
Tea Cup Garden	Heuchera 'Caramel'	
Tea Cup Garden	Heuchera 'Frosted Violet'	
Tea Cup Garden	Heuchera 'Glitter'	
Tea Cup Garden	Heuchera 'Grape Soda'	
Tea Cup Garden	Heuchera 'Southern Comfort'	
Tea Cup Garden	Holboellia sp. (JMW 17092)	
Tea Cup Garden	Hosta sieboldiana	
Tea Cup Garden	Isodon longitubus	
Tea Cup Garden	Jasminum nudiflorum	
Tea Cup Garden	Lactuca sativa 'Sandy'	Seasonal / Annual
Tea Cup Garden	Laurus nobilis [Sicilian Sunshine®] = 'LNSS'	Seasonal / Half Hardy
Tea Cup Garden	Lavandula x intermedia [Phenomenal] = 'Niko'	
Tea Cup Garden	Leucanthemum superbum 'Alaska'	Seasonal / Hardy
Tea Cup Garden	Leucosceptum stellipilum	
Tea Cup Garden	Lilium 'Claude Shride'	
Tea Cup Garden	Lilium 'Honeymoon'	
Tea Cup Garden	Lilium 'Landini'	
Tea Cup Garden	Lilium martagon 'Guinea Gold'	
Tea Cup Garden	Lilium 'Robina'	
Tea Cup Garden	Lilium 'Star Gazer'	
Tea Cup Garden	Liriope spicata	
Tea Cup Garden	Lonicera 'Mandarin'	
Tea Cup Garden	Lupinus polyphyllus 'Westcountry™ Salmon Star'	Seasonal / Annual
Tea Cup Garden	Milium effusum 'Aureum'	
Tea Cup Garden	Molinia caerulea ssp. arundinacea 'Transparent'	
Tea Cup Garden	Muscari armeniacum	
Tea Cup Garden	Narcissus 'Oxford Gold'	
Tea Cup Garden	Narcissus 'Sunlight Sensation'	
Tea Cup Garden	Narcissus 'Thalia'	
Tea Cup Garden	Narcissus 'White Petticoat'	
Tea Cup Garden	Ophiopogon intermedius 'Argenteomarginatus'	
Tea Cup Garden	Ornithogalum ponticum 'Sochi'	
Tea Cup Garden	Osmanthus fragrans 'Fudingzhu'	
Tea Cup Garden	Osteospermum [Bright Lights™ White] = 'KLEOE1732'	Seasonal / Annual
Tea Cup Garden	Osteospermum [FlowerPower™ Spider White] =	Seasonal / Annual
Tea Cup Garden	Paeonia 'Oochigeas'	
Tea Cup Garden	Papaver nudicaule 'Spring Fever Orange'	Seasonal / Annual
Tea Cup Garden	Papaver nudicaule 'Spring Fever Yellow'	Seasonal / Annual
Tea Cup Garden	Parthenocissus henryana	

garden bed plant list hardy and non-hardy plants growing in the entrance circle, teacup garden and island beds, 4/24/24

location	botanical name	
Tea Cup Garden	Parthenocissus tricuspidata 'Lowii'	
Tea Cup Garden	Perovskia atriplicifolia 'Little Spire'	
Tea Cup Garden	Perovskia atriplicifolia 'Rocketman'	
Tea Cup Garden	Rhodophiala bifida 'Hill Country Red'	
Tea Cup Garden	Rosa sericea ssp. omeiensis f. pteracantha	
Tea Cup Garden	Sabal minor (North East Texas)	
Tea Cup Garden	Sagina subulata 'Aurea'	Seasonal / Hardy
Tea Cup Garden	Salix sachalinensis 'Golden Sunshine'	
Tea Cup Garden	Salvia officinalis 'Icterina'	Seasonal / Hardy
Tea Cup Garden	Selaginella kraussiana 'Gold Tips'	Seasonal / Tender
Tea Cup Garden	Thuja occidentalis [Fire Chief] = 'Congabe'	
Tea Cup Garden	Tiarella cordifolia 'Brandywine'	Seasonal / Hardy
Tea Cup Garden	Tulipa (Lily-flowered Group) 'Green Star'	
Tea Cup Garden	Tulipa (Single Late Group) 'Belle Du Monde'	
Tea Cup Garden	Tulipa (Triumph Group) 'Apricot Foxx'	
Tea Cup Garden	Vaccinium corymbosum 'Blueray'	
Tea Cup Garden	Vaccinium corymbosum 'Patriot'	
Tea Cup Garden	Viola cornuta [Sorbet® XP Marina] = 'PAS912438'	Seasonal / Annual
Tea Cup Garden	Viola x wittrockiana 'Spring Matrix™ Lemon'	Seasonal / Annual
Tea Cup Garden	Vitis rotundifolia [RazzMatazz®] = '05-22-3-27'	
Tea Cup Garden	Wisteria frutescens 'Amethyst Falls'	
Tea Cup Garden	Wisteria macrostachya (blue form)	
Tea Cup Garden	Yucca cernua	
Tea Cup Garden	Yucca constricta	
Tea Cup Garden	Yucca elata	
Tea Cup Garden	Yucca gloriosa var. tristis	
Upper Border	Achillea ptarmica Pearl Group	
Upper Border	Actaea simplex (Atropurpurea Group) 'Hillside Black Beauty'	
Upper Border	Agapanthus 'Galaxy White'	
Upper Border	Ajuga reptans [Chocolate Chip] = 'Valfredda'	
Upper Border	Allium 'Ambassador'	
Upper Border	Allium 'Graceful'	
Upper Border	Allium nigrum	
Upper Border	Allium schubertii	
Upper Border	Allium sphaerocephalum	
Upper Border	Allium stipitatum 'Mount Everest'	
Upper Border	Allium stipitatum 'White Giant'	
Upper Border	Allium 'Summer Beauty'	
Upper Border	Amsonia (variable hybrids)	
Upper Border	Amsonia taberaemontana 'Blue Ice'	
Upper Border	Anemone [Fantasy™ Snow Angel] = 'Ifansa'	
Upper Border	Anemone blanda 'White Splendour'	
Upper Border	Anemone x hybrida 'Honorine Jobert'	
Upper Border	Aquilegia sp.	
Upper Border	Arum italicum 'Dr. Comstock'	
Upper Border	Aruncus aethusifolius	
Upper Border	Aruncus dioicus	
Upper Border	Aruncus 'Misty Lace'	
Upper Border	Asarum canadense	
Upper Border	Asarum splendens	
Upper Border	Astilbe 'Deutschland'	
Upper Border	Astilbe 'Snowdrift'	
Upper Border	Begonia grandis ssp. evansiana 'Alba'	
Upper Border	Betula nigra [Heritage®] = 'Cully'	
Upper Border	Borago officinalis 'Alba'	Seasonal / Annual

garden bed plant list hardy and non-hardy plants growing in the entrance circle, teacup garden and island beds, 4/24/24

location	botanical name
Upper Border	Brunnera macrophylla 'Betty Bowring'
Upper Border	Brunnera macrophylla 'Jack Frost'
Upper Border	Brunnera macrophylla 'Sea Heart'
Upper Border	Calamagrostis x acutiflora 'Avalanche'
Upper Border	Camellia 'Winter's Snowman'
Upper Border	Campanula glomerata [Genti White] = 'Allgentiw'
Upper Border	Carex oshimensis [EverColor® Everest] = 'Carfit01'
Upper Border	Caryopteris divaricata 'Snow Fairy'
Upper Border	Cephalotaxus harringtonii 'Duke Gardens'
Upper Border	Cephalotaxus harringtonii 'Prostrata'
Upper Border	Chelone glabra 'Black Ace'
Upper Border	Chionodoxa forbesii 'Blue Giant'
Upper Border	Chionodoxa luciliae 'Alba'
Upper Border	Clematis 'Duchess of Albany'
Upper Border	Clematis recta [Seriously Black] = 'Lime Close'
Upper Border	Colchicum 'Lilac Wonder'
Upper Border	Cornus alba [IVORY HALO] = 'Baihalo'
Upper Border	Cornus alba 'Argenteo-marginata'
Upper Border	Cornus alba 'Kesselringii'
Upper Border	Cornus kousa
Upper Border	Cornus sanguinea [Arctic Sun] = 'Canto'
Upper Border	Corylopsis 'Winterthur'
Upper Border	Cotinus coggygria Purpureus Group
Upper Border	Cotinus coggygria 'Royal Purple'
Upper Border	Cotinus coggygria 'Velvet Cloak'
Upper Border	Crambe maritima
Upper Border	Crocus vernus 'Jeanne d'Arc'
Upper Border	Daphniphyllum himalaense ssp. macropodium
Upper Border	Digitalis purpurea 'Snow Thimble'
Upper Border	Dryopteris erythrosora 'Brilliance'
Upper Border	Dryopteris x australis
Upper Border	Epimedium 'Domino'
Upper Border	Epimedium wushanense 'Sandy Claws'
Upper Border	Epimedium x youngianum 'Azusa'
Upper Border	Erythronium 'Pagoda'
Upper Border	Euphorbia amygdaloides var. robbiae
Upper Border	Fothergilla 'Mt. Airy'
Upper Border	Galanthus nivalis (Elizabeth Lawrence Strain)
Upper Border	Geranium 'Nimbus'
Upper Border	Geranium 'Orion'
Upper Border	Geum 'Mai Tai'
Upper Border	Gladiolus 'Boone'
Upper Border	Hakonechloa macra 'All Gold'
Upper Border	Hakonechloa macra 'Aureola'
Upper Border	Helleborus x hybridus 'Spanish Flare'
Upper Border	Hemerocallis 'Frans Hals'
Upper Border	Hemerocallis 'Heavenly Flight of Angels'
Upper Border	Hibiscus moscheutos 'Luna Rose'
Upper Border	Hosta plantaginea
Upper Border	Hosta 'Royal Standard'
Upper Border	Hosta 'So Sweet'
Upper Border	Hyacinthoides hispanica 'White City'
Upper Border	Hydrangea arborescens 'Annabelle'
Upper Border	Hydrangea macrophylla [Endless Summer®] = 'Bailmer'

garden bed plant list hardy and non-hardy plants growing in the entrance circle, teacup garden and island beds, 4/24/24

location	botanical name
Upper Border	Hydrangea macrophylla [Endless Summer®] = 'Blushing Bride'
Upper Border	Hydrangea macrophylla 'Nachtigall'
Upper Border	Hydrangea paniculata 'Summer Snow'
Upper Border	Hydrangea serrata 'Blue Billow'
Upper Border	Illicium floridanum 'Hally's Comet'
Upper Border	Impatiens balfourii
Upper Border	Ipheion 'Jessie'
Upper Border	Ipheion uniflorum 'White Star'
Upper Border	Ipheion uniflorum 'Wisley Blue'
Upper Border	Iris 'Batik'
Upper Border	Iris domestica
Upper Border	Iris 'Immortality'
Upper Border	Iris pallida 'Albo Variegata'
Upper Border	Iris 'Queen Dorothy'
Upper Border	Iris sibirica 'Nana Alba'
Upper Border	Iris tectorum 'Alba'
Upper Border	Isodon longitubus
Upper Border	Itea virginica 'Henry's Garnet'
Upper Border	Juniperus virginiana
Upper Border	Kalimeris pinnatifida 'Hortensis'
Upper Border	Klasea bulgarica
Upper Border	Kniphofia 'Alcazar'
Upper Border	Kniphofia 'Flamenco Mix'
Upper Border	Kniphofia 'Lady Luck'
Upper Border	Lamprocapnos spectabilis 'Alba'
Upper Border	Leucanthemella serotina
Upper Border	Leucanthemum x superbum 'Alaska'
Upper Border	Leucojum aestivum
Upper Border	Liatris spicata 'Floristan Weiss'
Upper Border	Lilium (African Queen Strain)
Upper Border	Lilium 'Beverly Dreams'
Upper Border	Lilium 'Casa Blanca'
Upper Border	Lilium 'Crystal Blanca'
Upper Border	Lilium martagon 'Russian Morning'
Upper Border	Lilium 'Orange Marmalade'
Upper Border	Lunaria annua 'Rosemary Verey'
Upper Border	Matteuccia struthiopteris
Upper Border	Mazus reptans 'Alba'
Upper Border	Microbiota decussata
Upper Border	Molinia caerulea 'Heidebraut'
Upper Border	Molinia caerulea ssp. arundinacea 'Windspiel'
Upper Border	Muscari armeniacum 'Siberian Tiger'
Upper Border	Muscari armeniacum 'White Magic'
Upper Border	Narcissus (Sunny All-Yellow Mixture)
Upper Border	Narcissus 'Chromacolor'
Upper Border	Narcissus 'Katie Heath'
Upper Border	Narcissus obvallaris
Upper Border	Narcissus 'Pistachio'
Upper Border	Narcissus 'Segovia'
Upper Border	Narcissus 'Stainless'
Upper Border	Narcissus 'Tête-à-Tête'
Upper Border	Paeonia 'Callie's Memory'
Upper Border	Paeonia 'Carrara'
Upper Border	Paeonia 'Immaculée'
Upper Border	Paeonia lactiflora 'Krinkled White'

garden bed plant list hardy and non-hardy plants growing in the entrance circle, teacup garden and island beds, 4/24/24

location	botanical name
Upper Border	<i>Paeonia ostii</i> 'Phoenix White'
Upper Border	<i>Papaver orientale</i> 'Royal Wedding'
Upper Border	<i>Persicaria amplexicaulis</i> 'Firetail'
Upper Border	<i>Phlox carolina</i> 'Miss Lingard'
Upper Border	<i>Phlox</i> 'Minnie Pearl'
Upper Border	<i>Phlox paniculata</i> 'David'
Upper Border	<i>Phlox stolonifera</i> 'Bruce's White'
Upper Border	<i>Picea omorika</i>
Upper Border	<i>Picea orientalis</i>
Upper Border	<i>Platycodon grandiflorus</i> (Astra Series Group) 'Astra White'
Upper Border	<i>Polygonatum odoratum</i> 'Variegatum'
Upper Border	<i>Primula</i> 'Jessica'
Upper Border	<i>Primula sieboldii</i> 'Fuji Snow'
Upper Border	<i>Prunus mume</i> 'Hanakami'
Upper Border	<i>Rhododendron</i> 'Mandarin Lights'
Upper Border	<i>Rhododendron</i> 'Weston's Lemon Drop'
Upper Border	<i>Rhus typhina</i> [Tiger Eyes®] = 'Bailtiger'
Upper Border	<i>Rhus typhina</i> 'Laciniata'
Upper Border	<i>Rosa</i> [At Last™] = 'HORCOGJIL'
Upper Border	<i>Rosa glauca</i>
Upper Border	<i>Rosa</i> 'Veilchenblau'
Upper Border	<i>Rudbeckia laciniata</i> 'Herbstsonne'
Upper Border	<i>Salvia sclarea</i> 'Vatican White'
Upper Border	<i>Salvia x sylvestris</i> 'Schneeh,,gel'
Upper Border	<i>Schizophragma hydrangeoides</i> 'Moonlight'
Upper Border	<i>Sciadopitys verticillata</i>
Upper Border	<i>Scilla siberica</i>
Upper Border	<i>Stachys byzantina</i> 'Countess Helene von Stein'
Upper Border	<i>Stachys officinalis</i> 'Hummelo'
Upper Border	<i>Stokesia laevis</i> 'Peach Melba'
Upper Border	<i>Syringa reticulata</i> ssp. <i>amurensis</i>
Upper Border	<i>Taxodium distichum</i> 'Falling Waters'
Upper Border	<i>Thalictrum pubescens</i>
Upper Border	<i>Torreya jackii</i>
Upper Border	<i>Tricyrtis formosana</i> 'Autumn Glow'
Upper Border	<i>Tulipa</i> (Darwin Hybrid Group) 'Hakuun'
Upper Border	<i>Tulipa</i> (Double Late Group) 'Mount Tacoma'
Upper Border	<i>Tulipa</i> (Forsteriana Group) 'Purissima'
Upper Border	<i>Tulipa</i> (Triumph Group) 'Antarctica'
Upper Border	<i>Vaccinium</i> 'Pink Lemonade'
Upper Border	<i>Viburnum opulus</i> 'Xanthocarpum'
Upper Border	<i>Viola odorata</i> 'Rebecca'
Upper Border	<i>Vitex agnus-castus</i> [Blue Diddley®] = 'SMVACBD'
Upper Border	x <i>Gordlinia grandiflora</i>
West Side	<i>Anemone blanda</i> 'Blue Shades'
West Side	<i>Aucuba japonica</i> 'Rozannie'
West Side	<i>Carex oshimensis</i> 'Evercolor Everillo'

